



Visit [www.knex.com/instructions](http://www.knex.com/instructions) and enter code 12122 to find instructions for these model ideas.

Visite [www.knex.com/instructions](http://www.knex.com/instructions) et entre le code 12122 pour trouver des instructions pour ces idées de jouet.

**WARNING:** CHOKING HAZARD - Small parts. Not for children under 3 years.

**AVERTISSEMENT:** DANGER D'ÉTOUFFEMENT - Pièces de petite taille. Ne pas donner aux enfants de moins de 3 ans.

12122

- Identifies Genuine K'NEX Bricks.
- Identifie que ce sont d'authentiques briques K'NEX.
- Identifica los ladrillos genuinos de K'NEX.
- Identifiziert echte K'NEX-Bausteine.
- Edentifica i veri blocchi K'NEX.
- Identifica que são cubos genuinos da K'NEX.
- Identificeert K'NEX bakstenen voor.

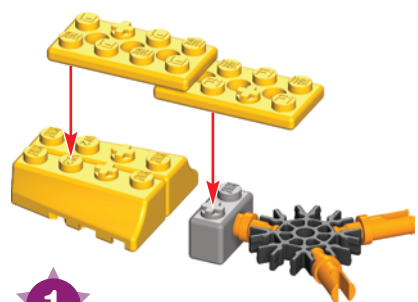

1

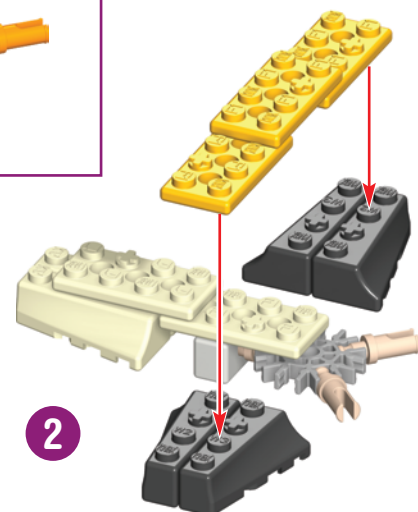

2

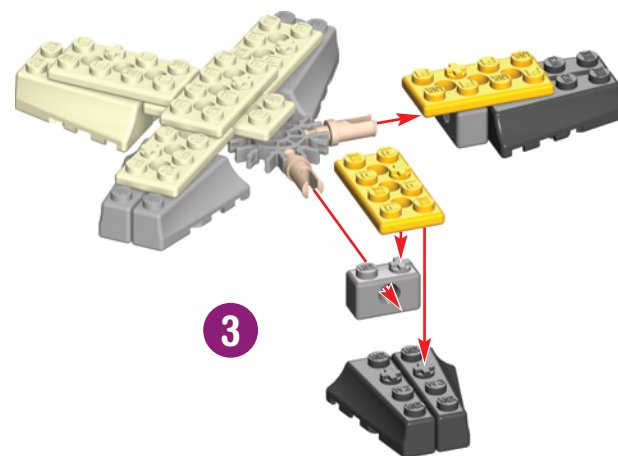

3



1 - 3

1-800-KID-KNEX (USA/États-Unis/CAN) • email@knex.com • www.knex.com  
 K'NEX and Imagine, Build, Play are registered trademarks of K'NEX Limited Partnership Group. Product & colors may vary. Most models can be built one at a time. Standard K'NEX parts made in the USA. Special components made in China. (FR) K'NEX et Imagine, Build, Play sont des marques déposées de K'NEX Limited Partnership Group. Produits et couleurs peuvent varier. La plupart des modèles ne peuvent être construits que un à un. Pièces K'NEX courantes fabriqués aux États-Unis. Éléments spéciaux fabriqués en Chine. (ES) K'NEX y Imagine, Build, Play son marcas registradas de K'NEX Limited Partnership Group. El producto y los colores pueden variar. La mayoría de los modelos se puede construir uno a la vez. Piezas estándar de K'NEX hechas en EE.UU. Componentes especiales hechos en China.  
 112122-V1-04/10

©2010 K'NEX Limited Partnership Group  
 P.O. Box 700  
 Hatfield, PA 19440-0700  
 USA



0-3

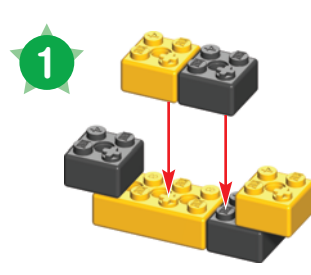

1

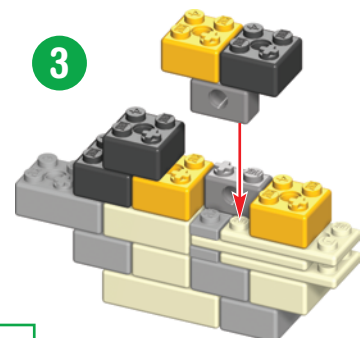

3

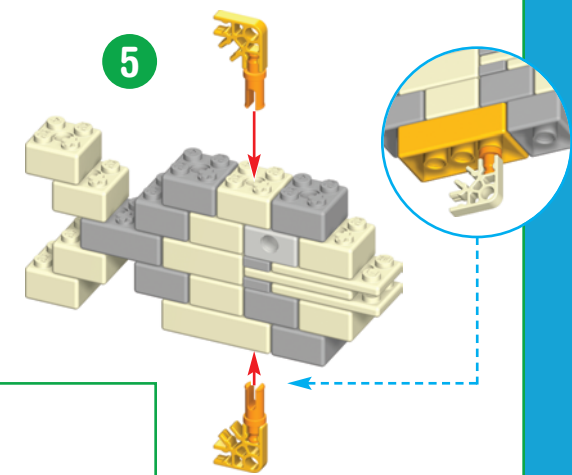

5

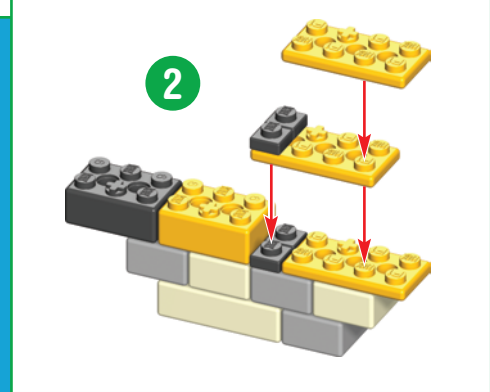

2

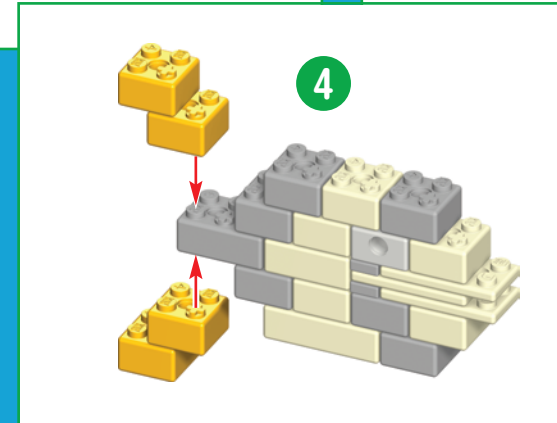

4



1 - 5

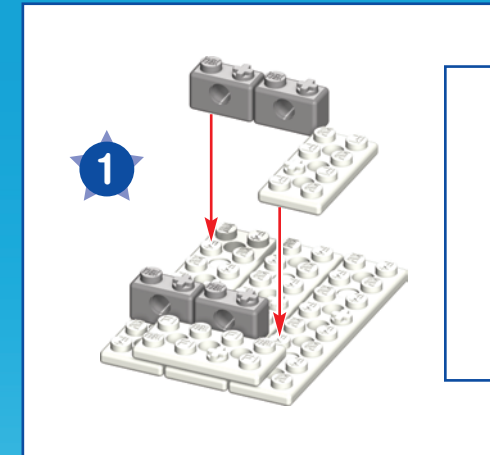

1

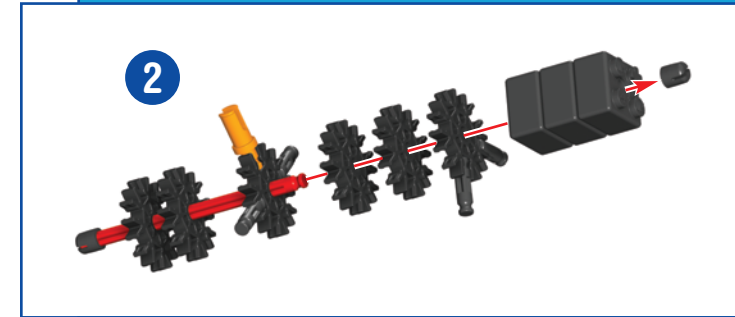

2

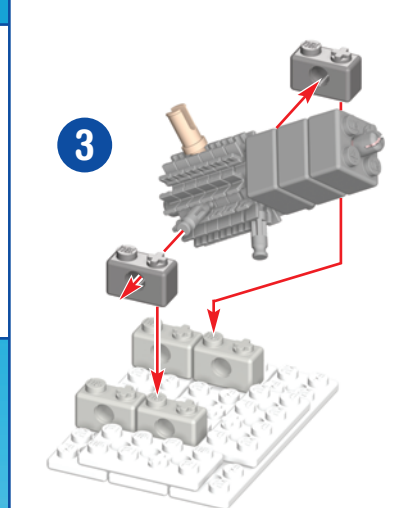

3



1 - 3

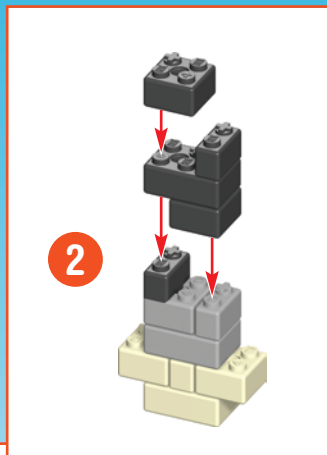

2

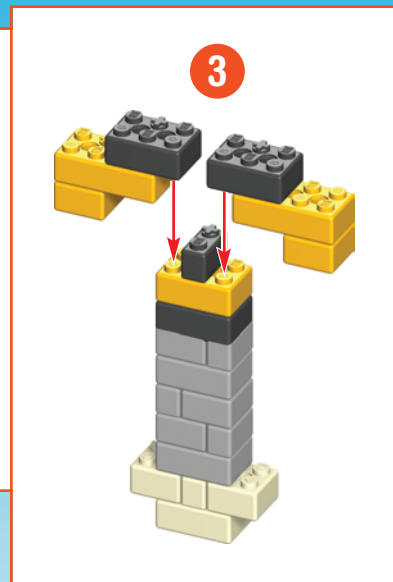

3

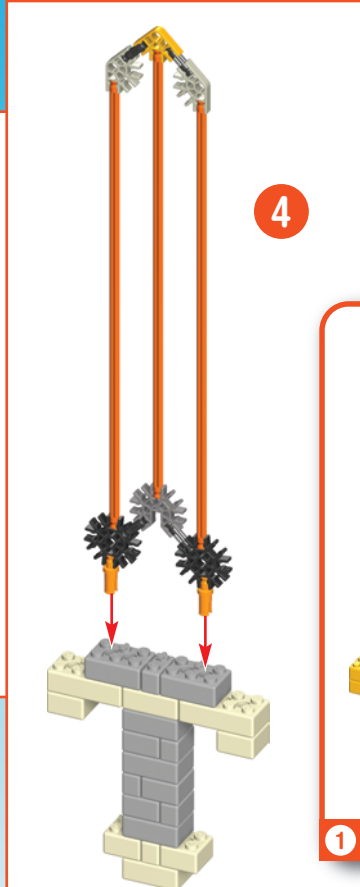

4

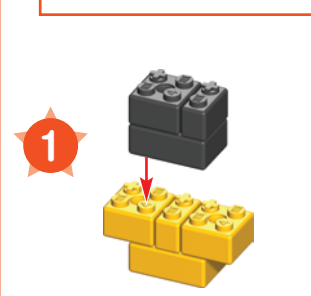

1



1 - 4

