



**Customize 3 Bikes!**  
One at a Time.  
**Personnalise 3 Motos!**  
Une à la fois.

**! WARNING:**

CHOKING HAZARD - Small parts.  
Not for children under 3 years.

**! AVERTISSEMENT:**

DANGER D'ÉTOUFFEMENT - Pièces de petite taille.  
Ne pas donner aux enfants de moins de 3ans.

**CUSTOM BIKE SHOP™**

**8+**

**Building System**  
**Système De Construction**

# K'NEX

## 3 BIKES TO BUILD!

**CRUISIN' TRIKE**

(page 6)

**STRETCH CHOPPER**

(page 14)

**FRONT-AXLE BIKE**

(page 20)

Get more, See more, Do more!

Obtiens plus, Vois plus, Fais plus !



**FIRE IT UP!**

**Fais-la vrombir !**

REAL SOUND/DE VRAIS EFFETS SONORES

**Attach the TANK**  
Fixe le RÉSERVOIR

**Fit the PIPES**  
Fixe les TUYAUX

**CUSTOM BIKE SHOP™**

**Fit the MOTOR**  
Encastre le MOTEUR

# K'NEX

## 3 BIKES TO BUILD!

**CRUISIN' TRIKE**

(page 6)

**STRETCH CHOPPER**

(page 14)

**FRONT-AXLE BIKE**

(page 20)

Get more, See more, Do more!

Obtiens plus, Vois plus, Fais plus !



**FIRE IT UP!**

**Fais-la vrombir !**

REAL SOUND/DE VRAIS EFFETS SONORES

**Attach the TANK**  
Fixe le RÉSERVOIR

**Fit the PIPES**  
Fixe les TUYAUX

**CUSTOM BIKE SHOP™**

**Fit the MOTOR**  
Encastre le MOTEUR

# K'NEX Building Basics



“Hi! I’m your K’NEX Building Buddy. When you see me in the instructions, you’ll want to pay close attention to the details being pointed out.”

## Ready, Set, Build

To begin your model, find the **1** and follow the numbers. Each piece has its own shape and color. Just look at the picture, find the pieces in your set that match what you see, and snap them together. Try to hold your model in the same direction as in the picture so you’ll attach your pieces to the right place.

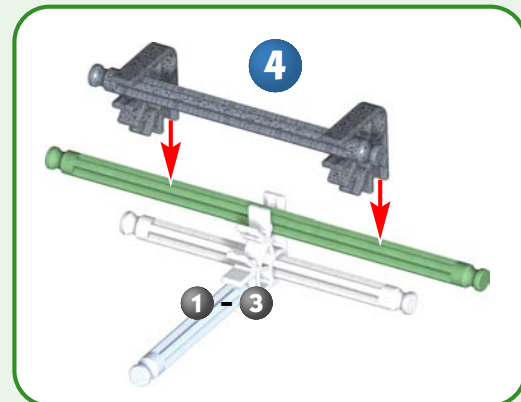
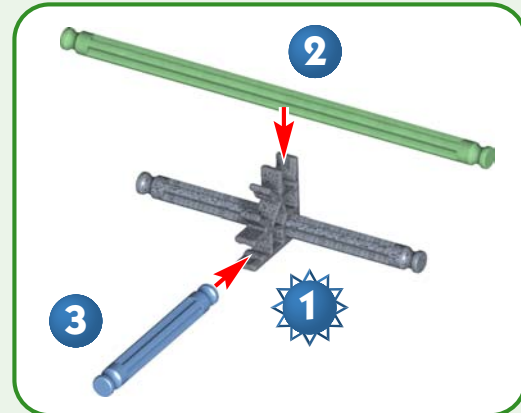

## Movin’ On

The faded colors tell you this section is already built. You’ll want to connect the new section to the place where the arrows are pointing. These pieces will be in full color.

## Spacers

There are places in your model where you need to add blue and silver Spacers. Be sure to count them carefully.



## Connectors

There are silver Connectors with special long slots. They slide together as you see in the pictures. Push the parts together until you hear a “click”.

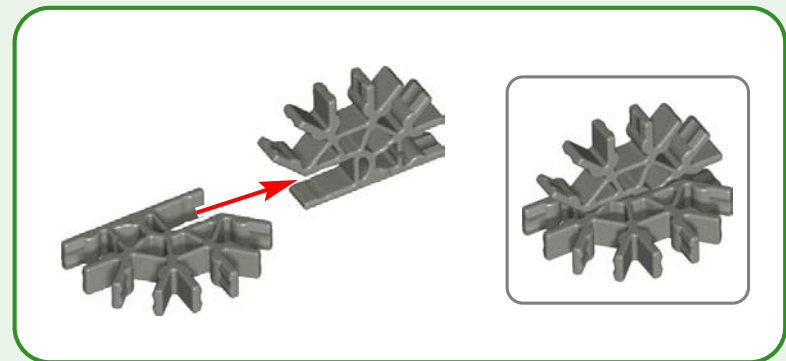

## Flexi-rods

A Flexi-rod is a Rod that you bend to make curves. It will be easier to attach to your model if you bend it back and forth first.



## FCC Statements:

This device complies with Part 15 of the FCC Rules. Operation is subject to the following two conditions:

1. This device may not cause harmful interference and
2. This device must accept any interference received, including interference that may cause undesired operation. This model is tested to comply with FCC standards - FOR HOME OR OFFICE USE.

This equipment has been tested and found to comply with the limits for a Class B digital device, pursuant to part 15 of the FCC Rules. These limits are designed to provide reasonable protection against harmful interference in a residential installation. This equipment generates, uses and can radiate radio frequency energy, and, if not installed and used in accordance with the instructions, may cause harmful interference to radio communications. However, there is no guarantee that interference will not occur in a particular installation. If this equipment does cause harmful interference to radio or television reception, which can be determined by turning the equipment off and on, the user is encouraged to try to correct the interference by one or more of the following measures: (1) Reorient or relocate the receiving antenna. (2) Increase the separation between the equipment and receiver. (3) Consult the dealer or an experienced radio/TV technician.

This Class B digital apparatus complies with Canadian ICES-003.

## BUILDING TIPS:



- Try to face your model in the same direction as shown in the instructions.
- Some steps include pieces that require a strong “push” to snap together. You might want to ask an adult for help.



# CRUISIN' TRIKE

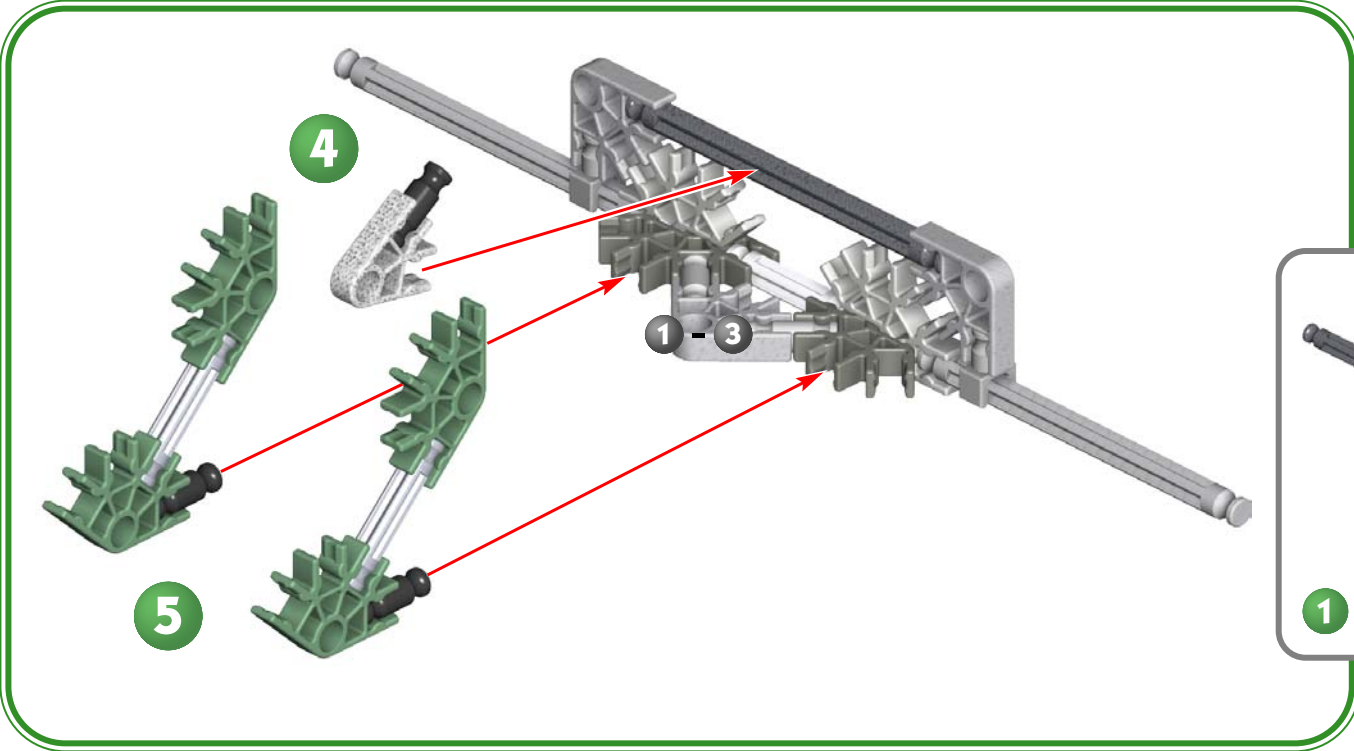
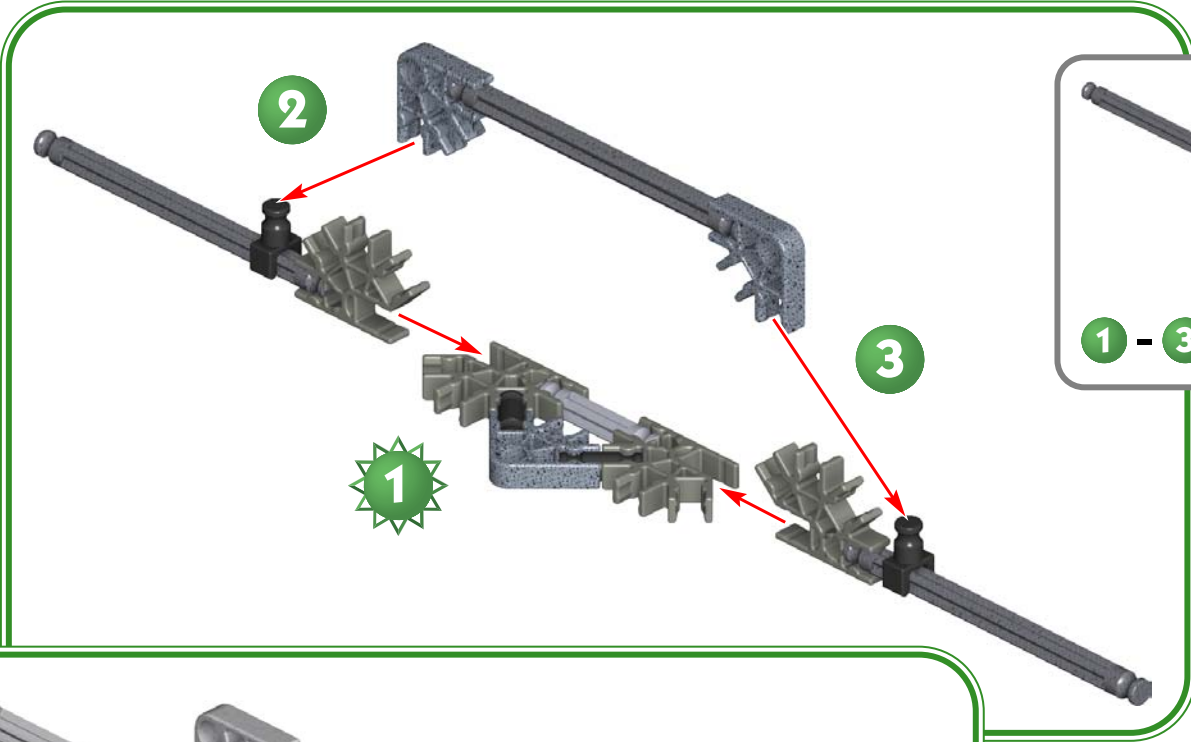

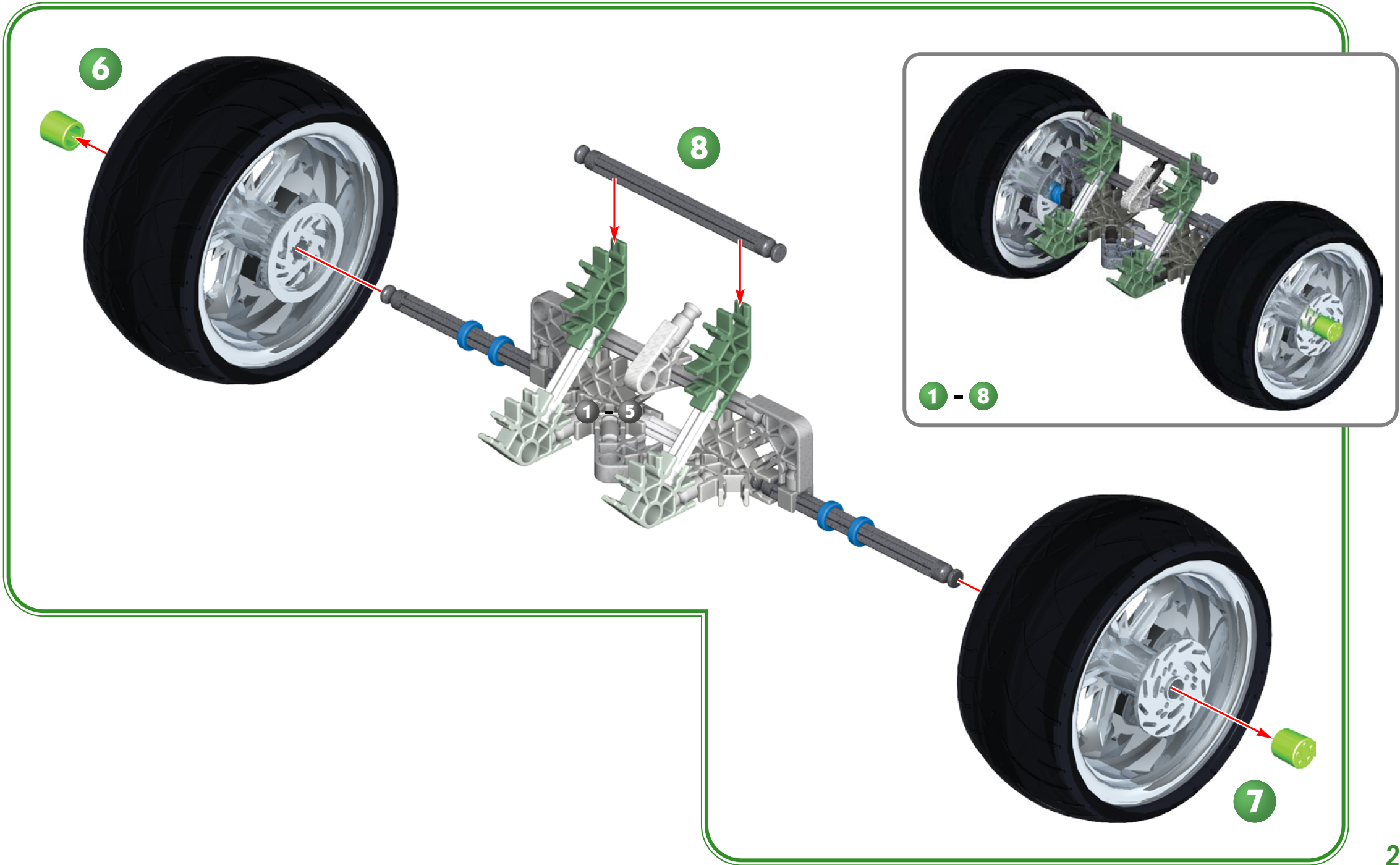

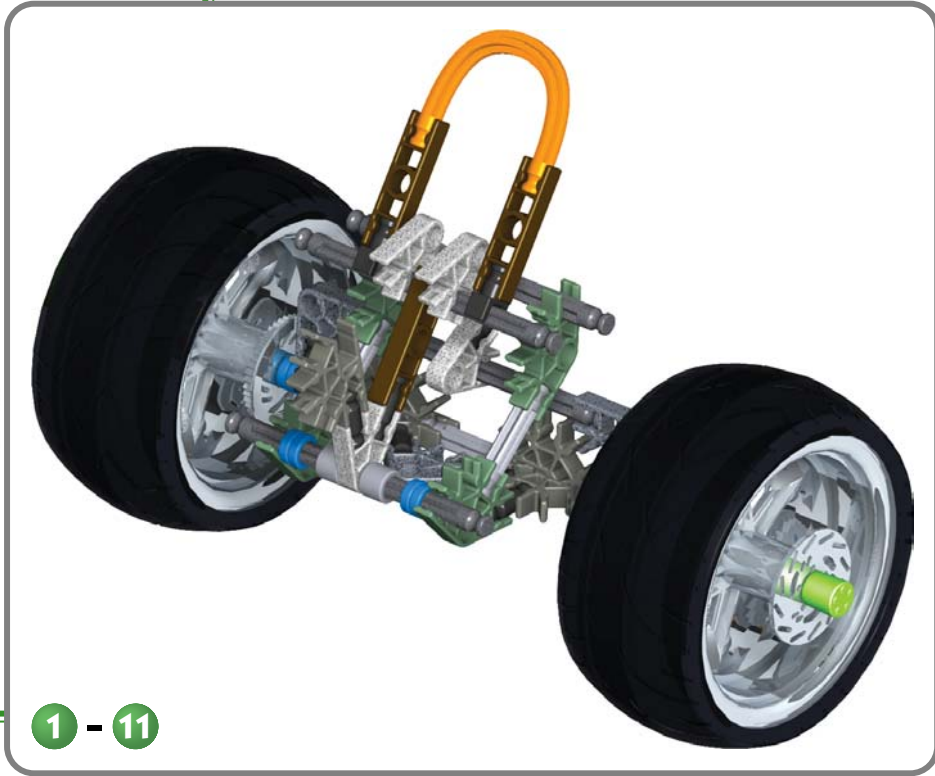
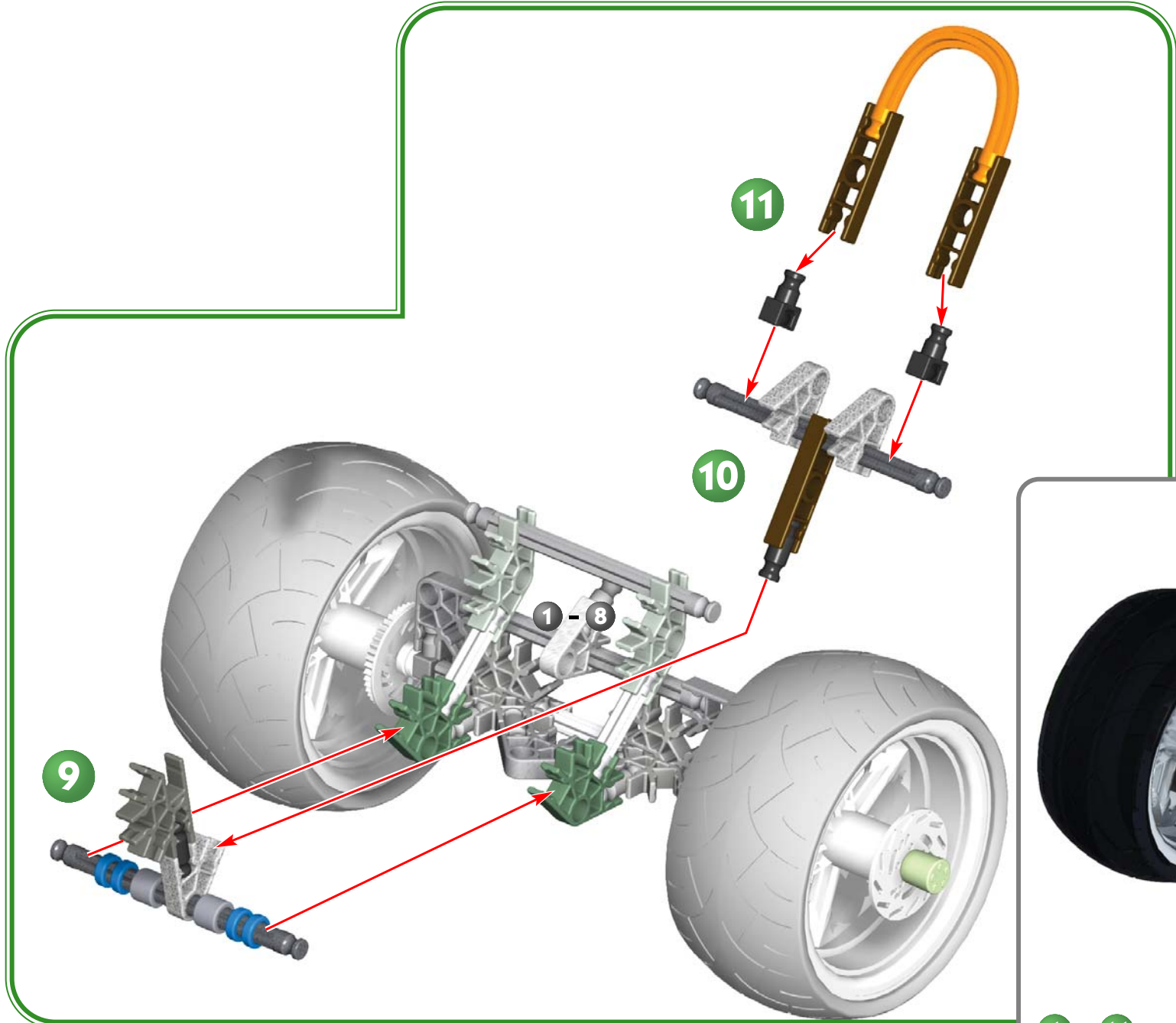

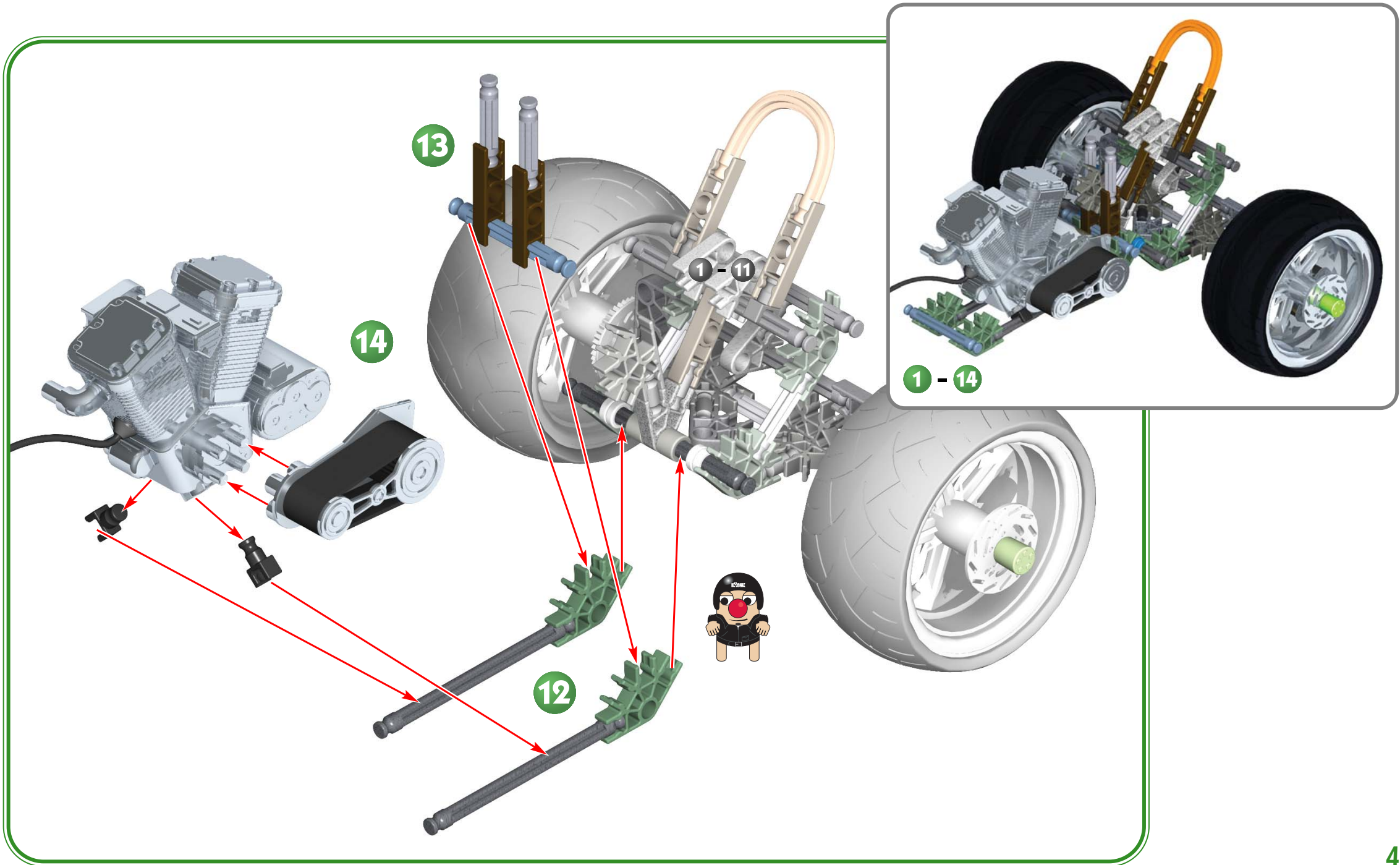

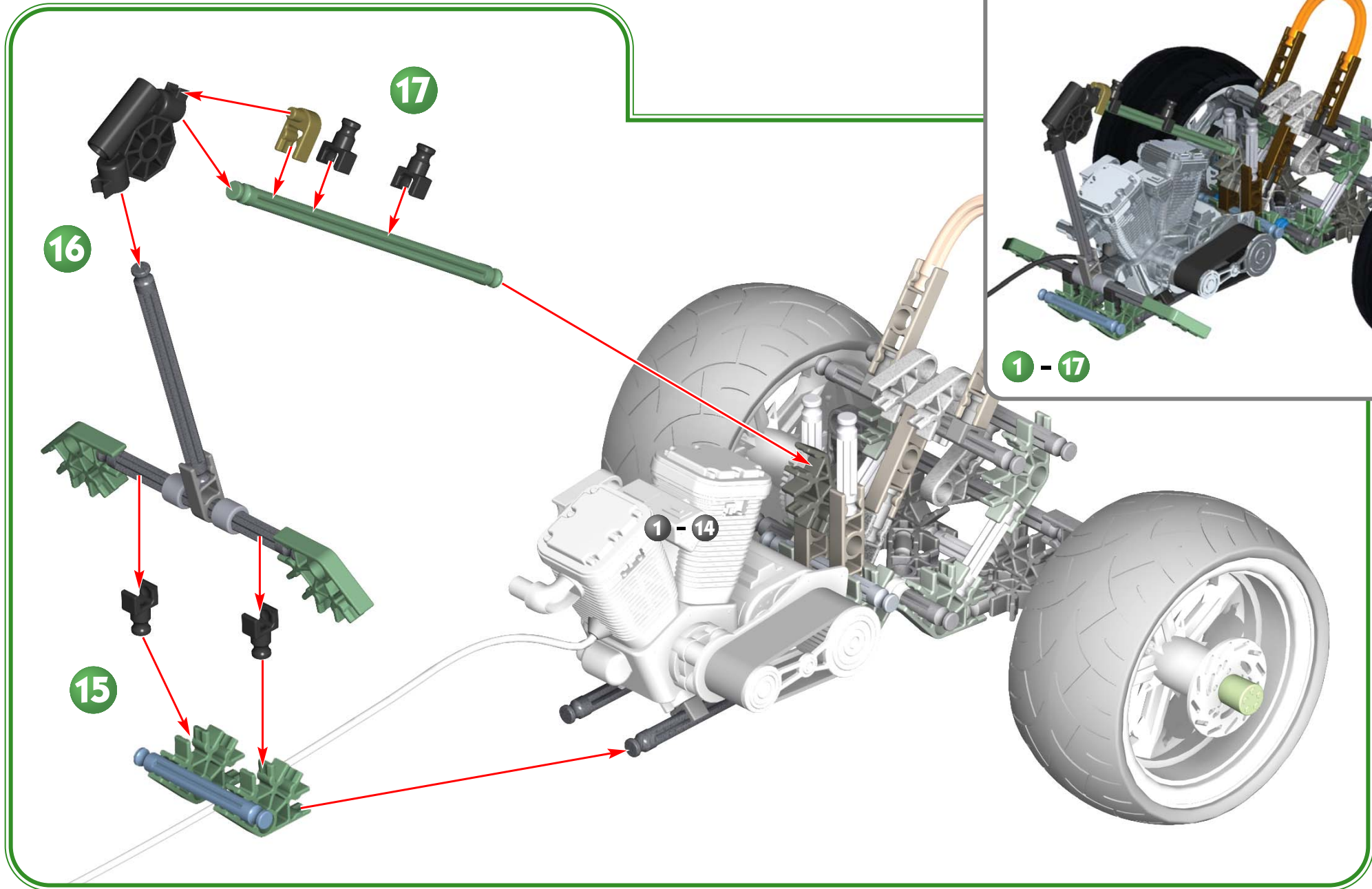

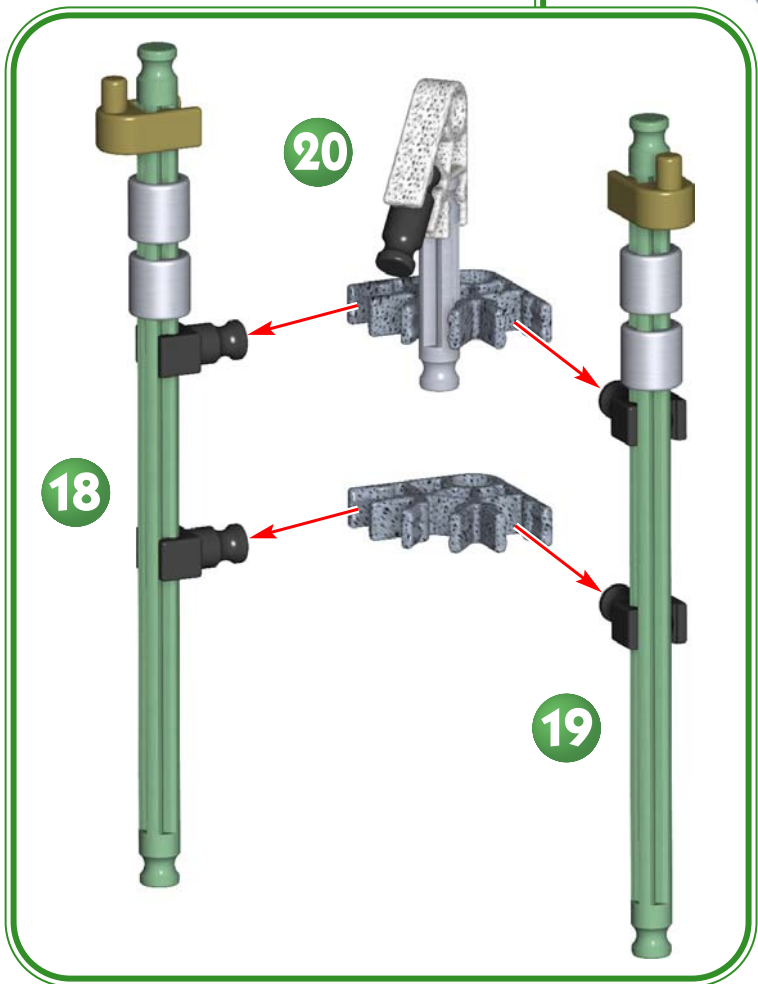
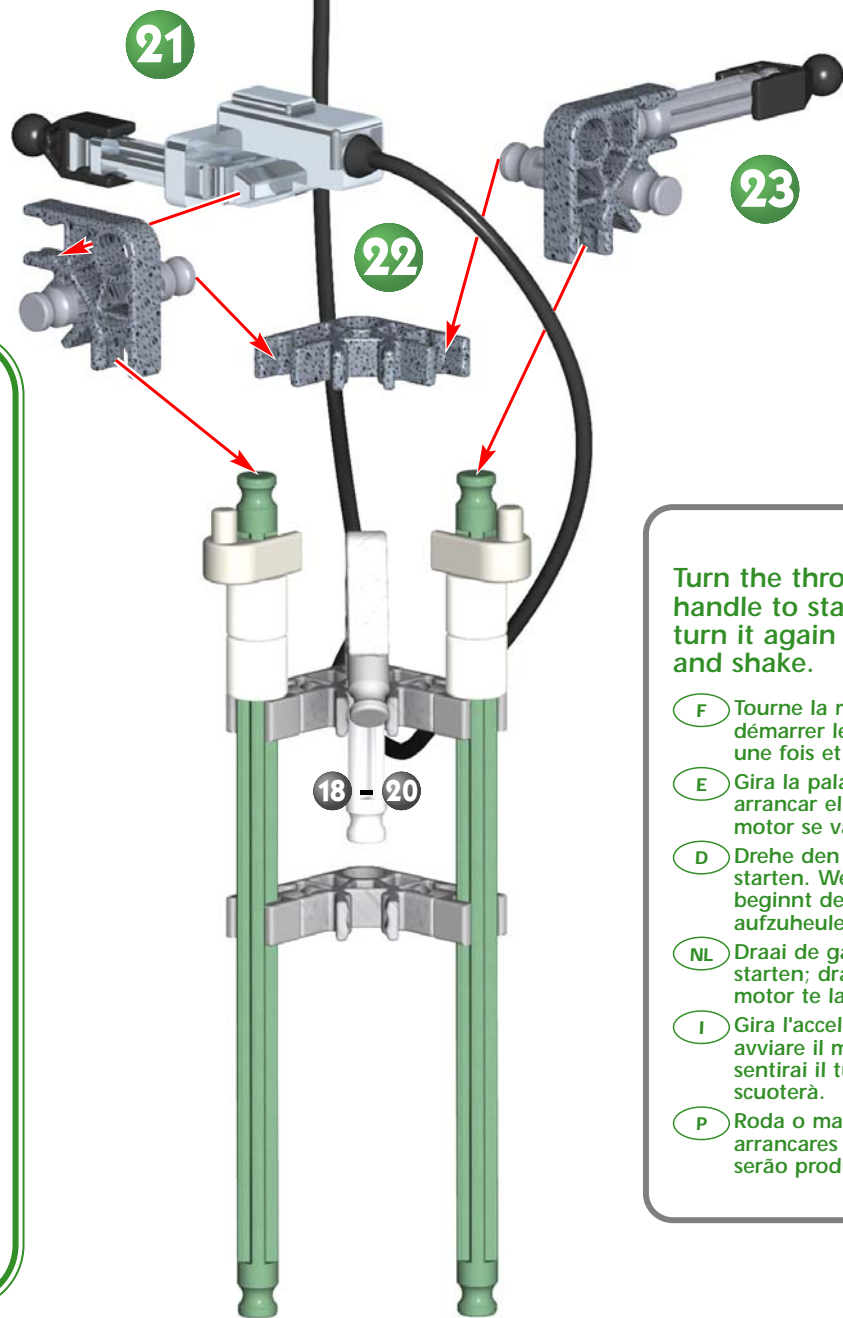

Turn the throttle handle to start the motor; turn it again and it will rev up and shake.

- F Tourne la manette des gaz pour faire démarrer le moteur ; tourne-la encore une fois et le moteur rugit et vrombit.
- E Gira la palanca del regulador para arrancar el motor; girala otra vez y el motor se va a acelerar y sacudir.
- D Drehe den Gashebel, um den Motor zu starten. Wenn du ihn erneut drehst, beginnt der Motor zu wackeln und aufzuheulen.
- NL Draai de gashendel om de motor te starten; draai hem nog een keer om te motor te laten brullen en schudden.
- I Gira l'acceleratore sul manubrio per avviare il motore, poi giralo di nuovo e sentirai il tutto gas e la moto si scuoterà.
- P Roda o manipulo de aceleração para arrancares o motor; roda novamente e serão produzidas rotações e vibrações.

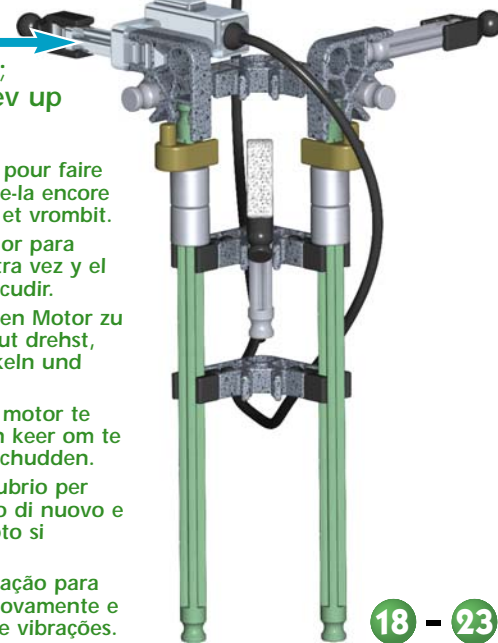

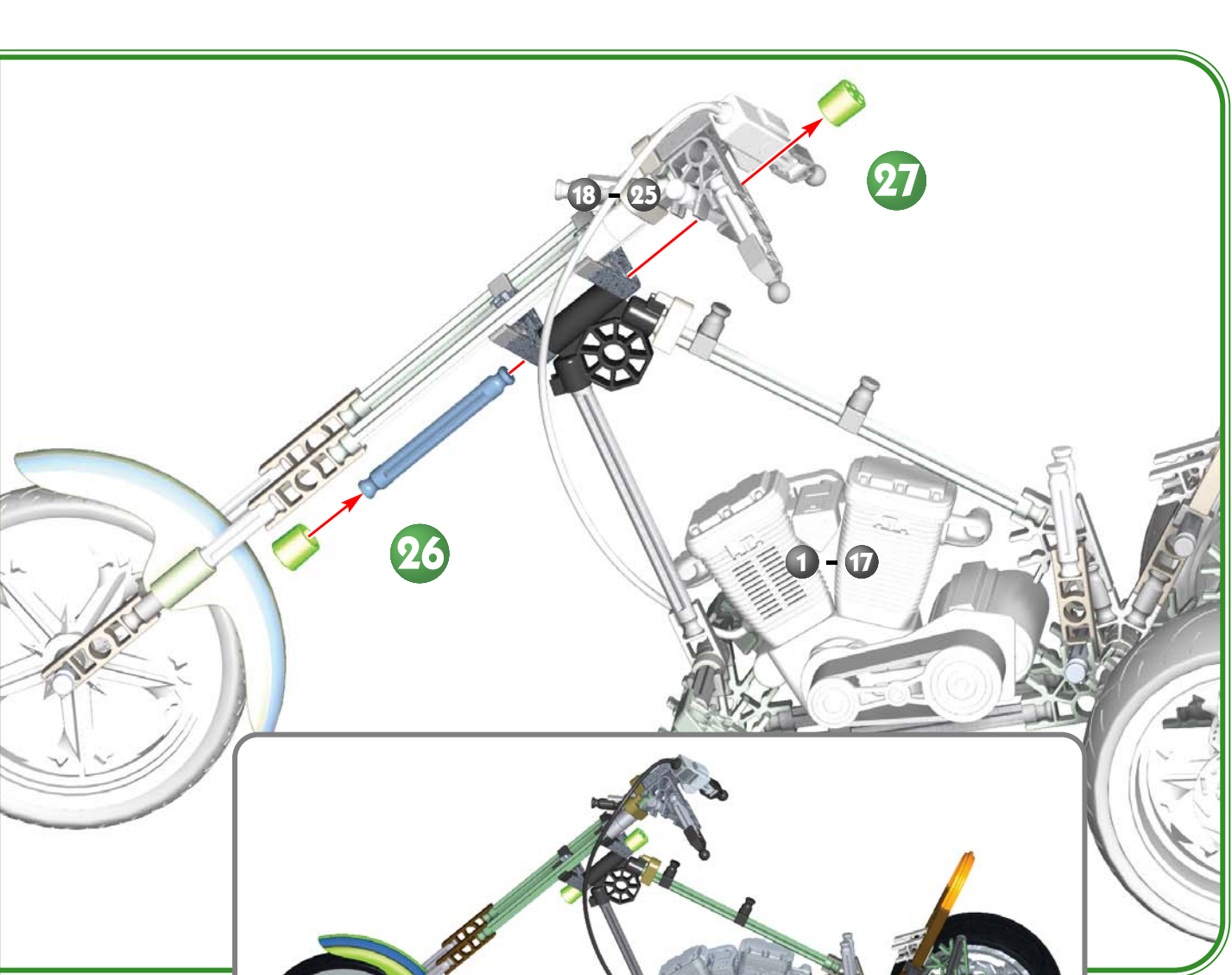
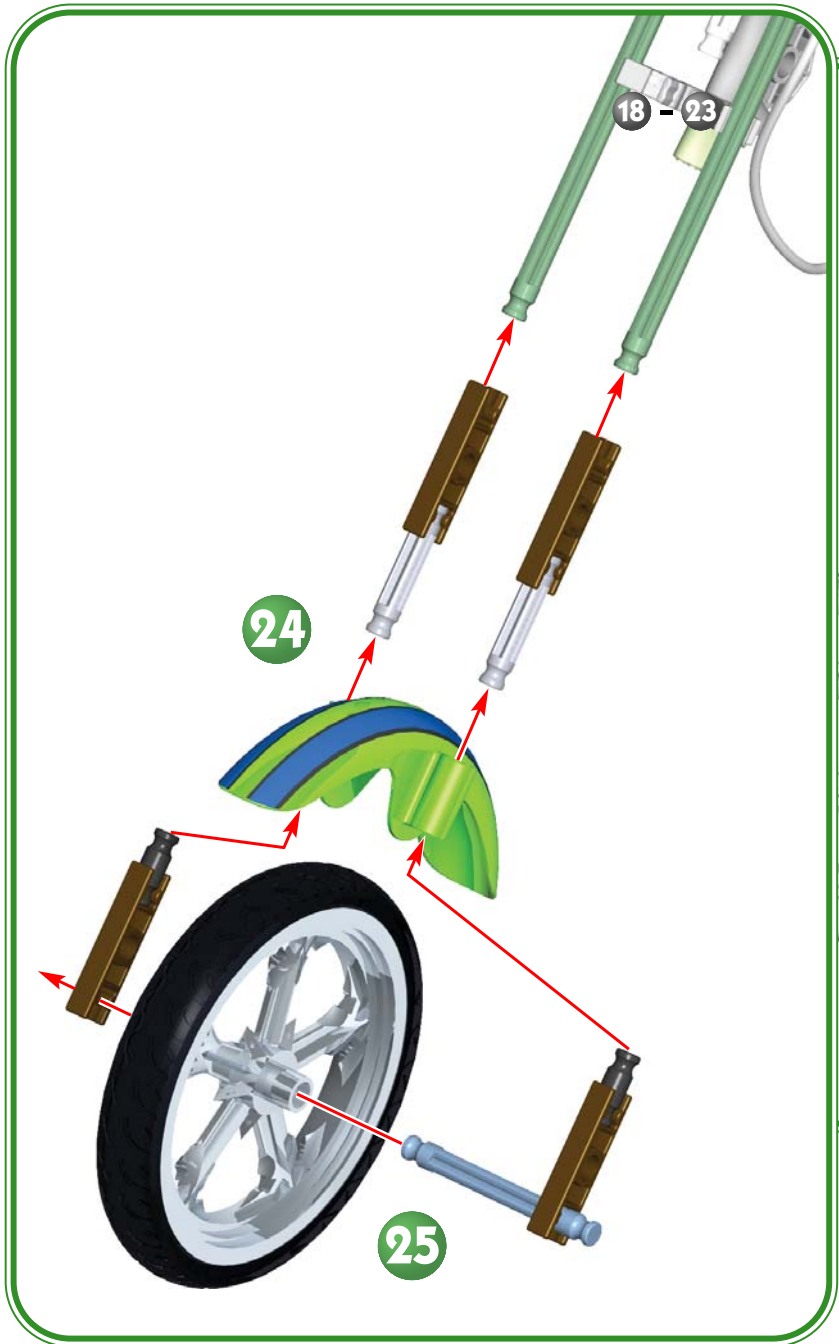

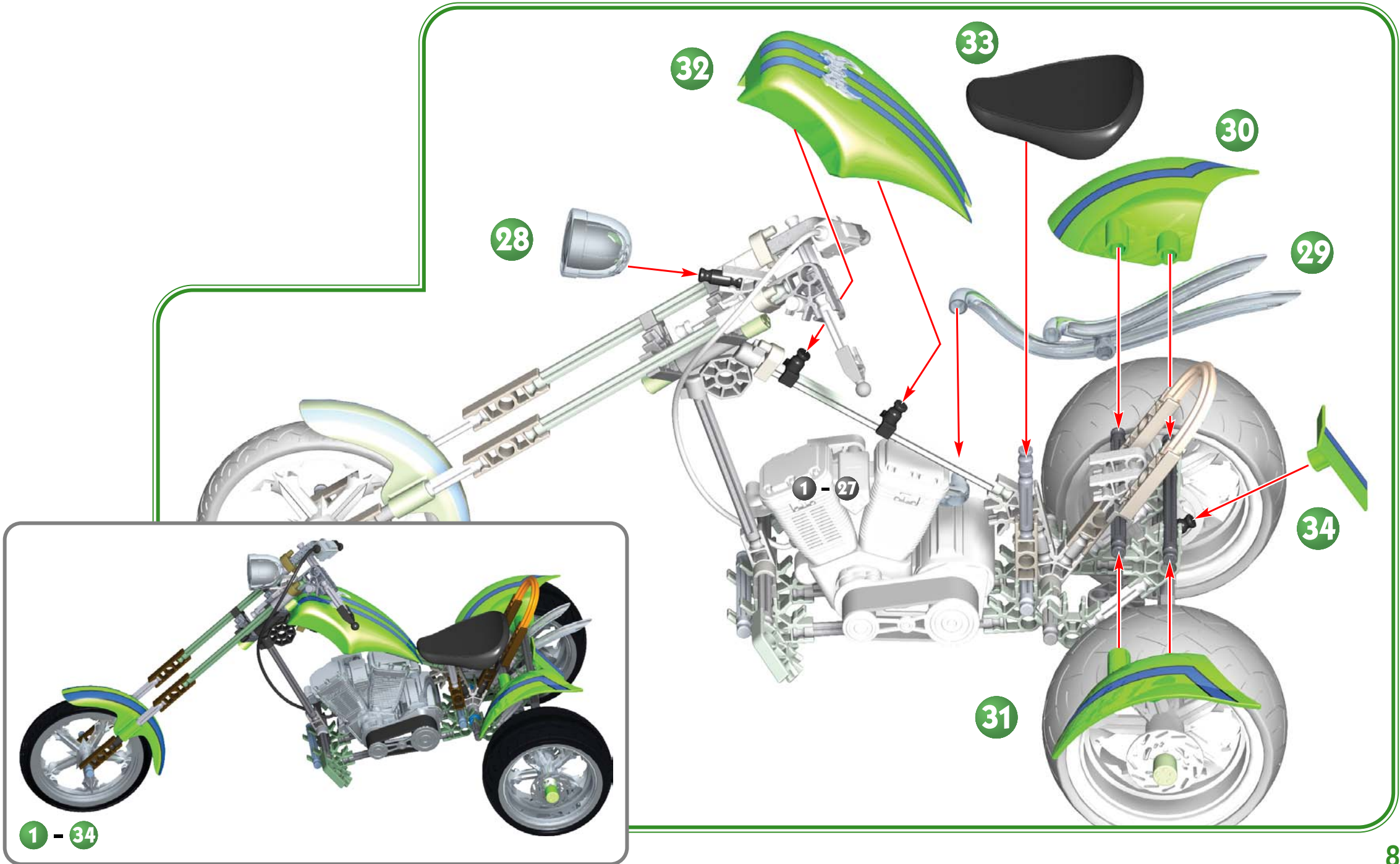

# STRETCH CHOPPER

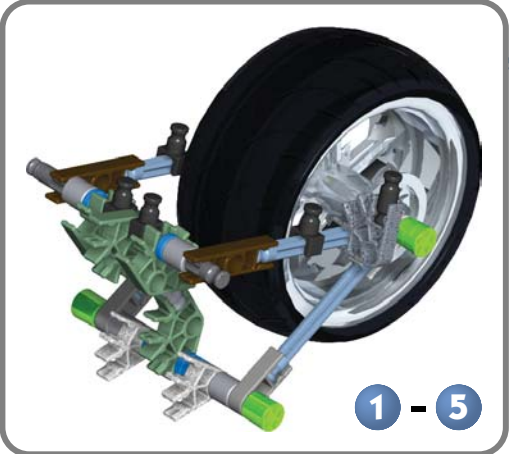
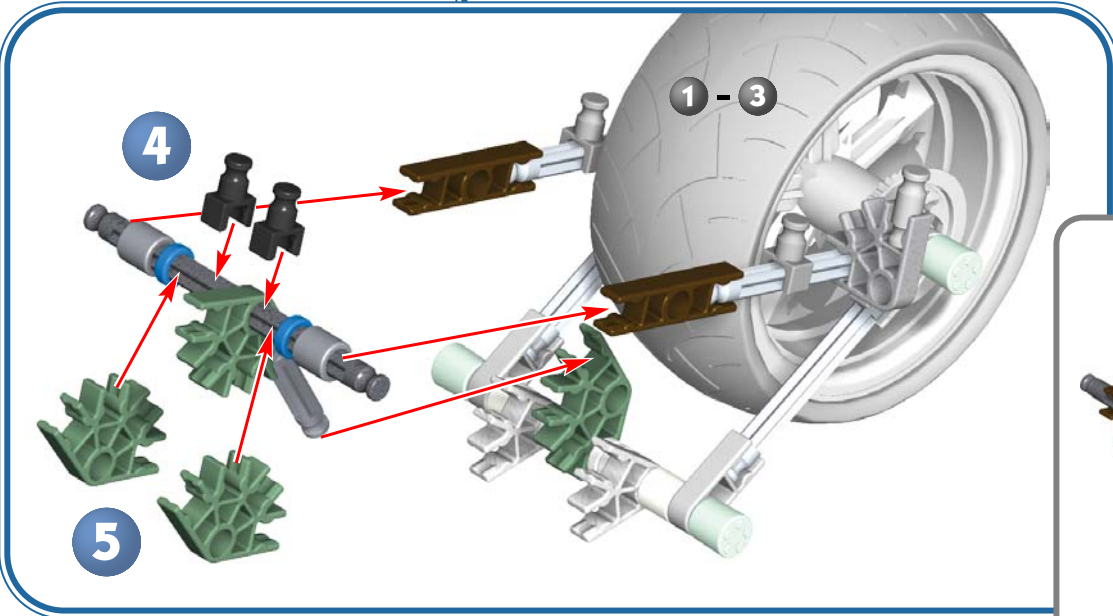
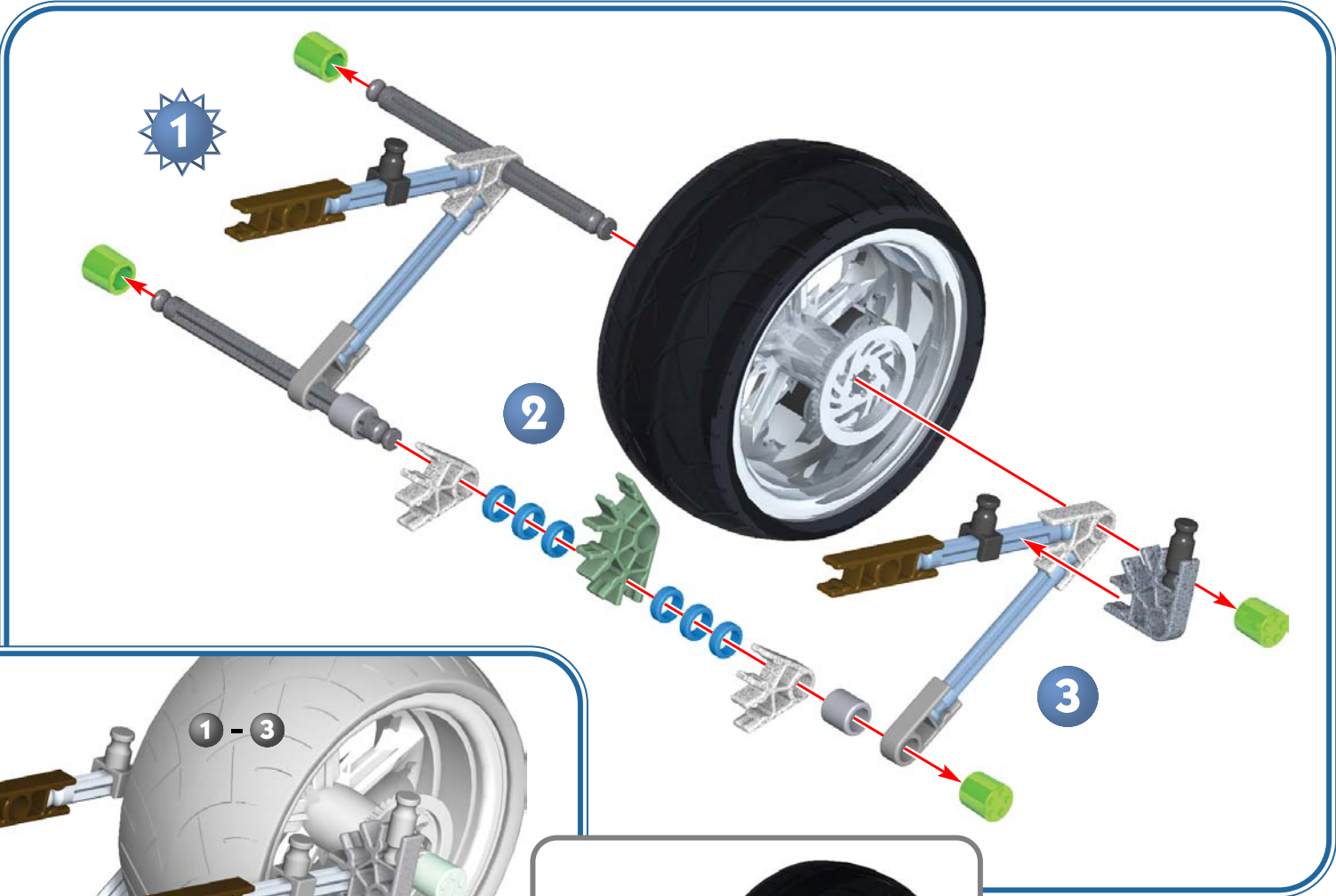

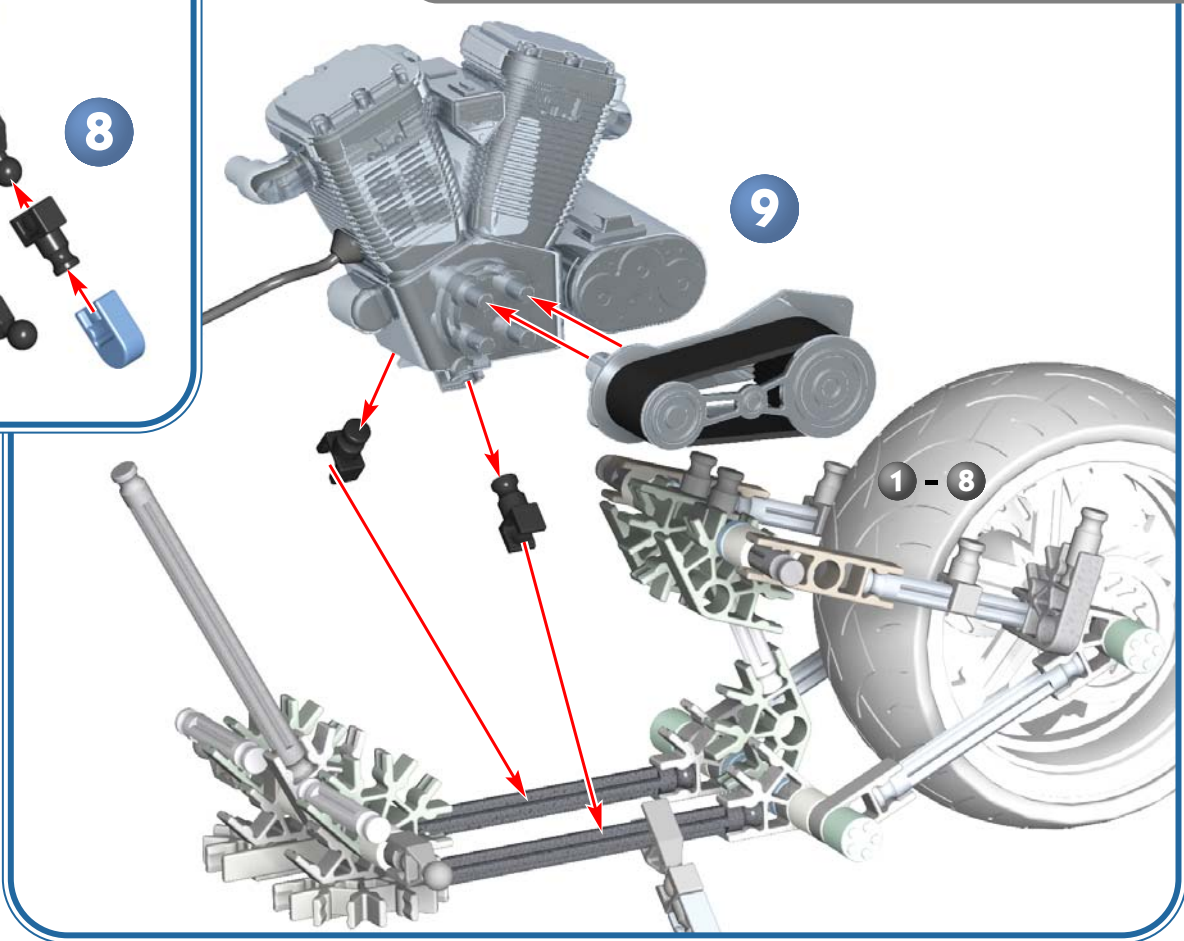
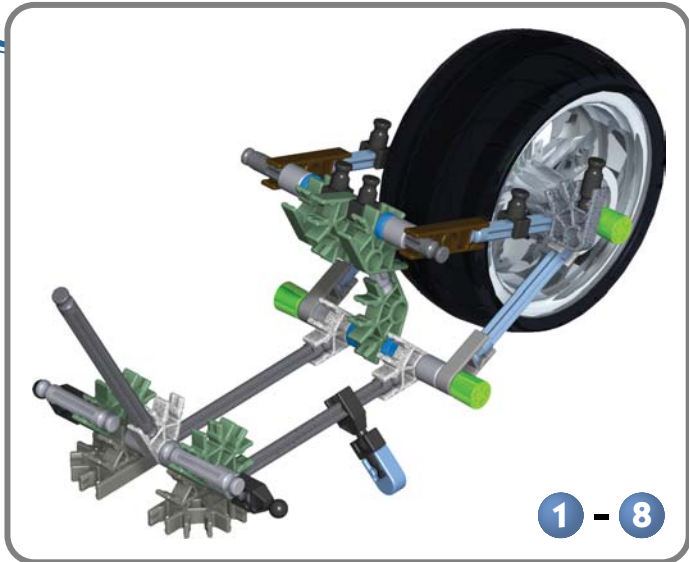
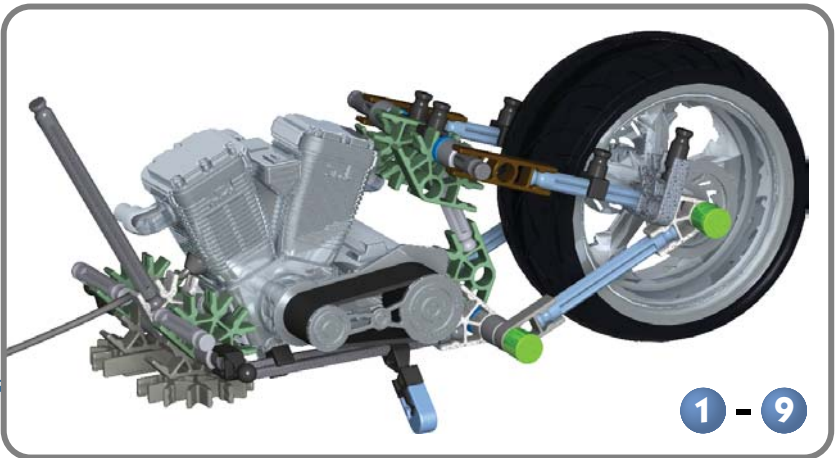
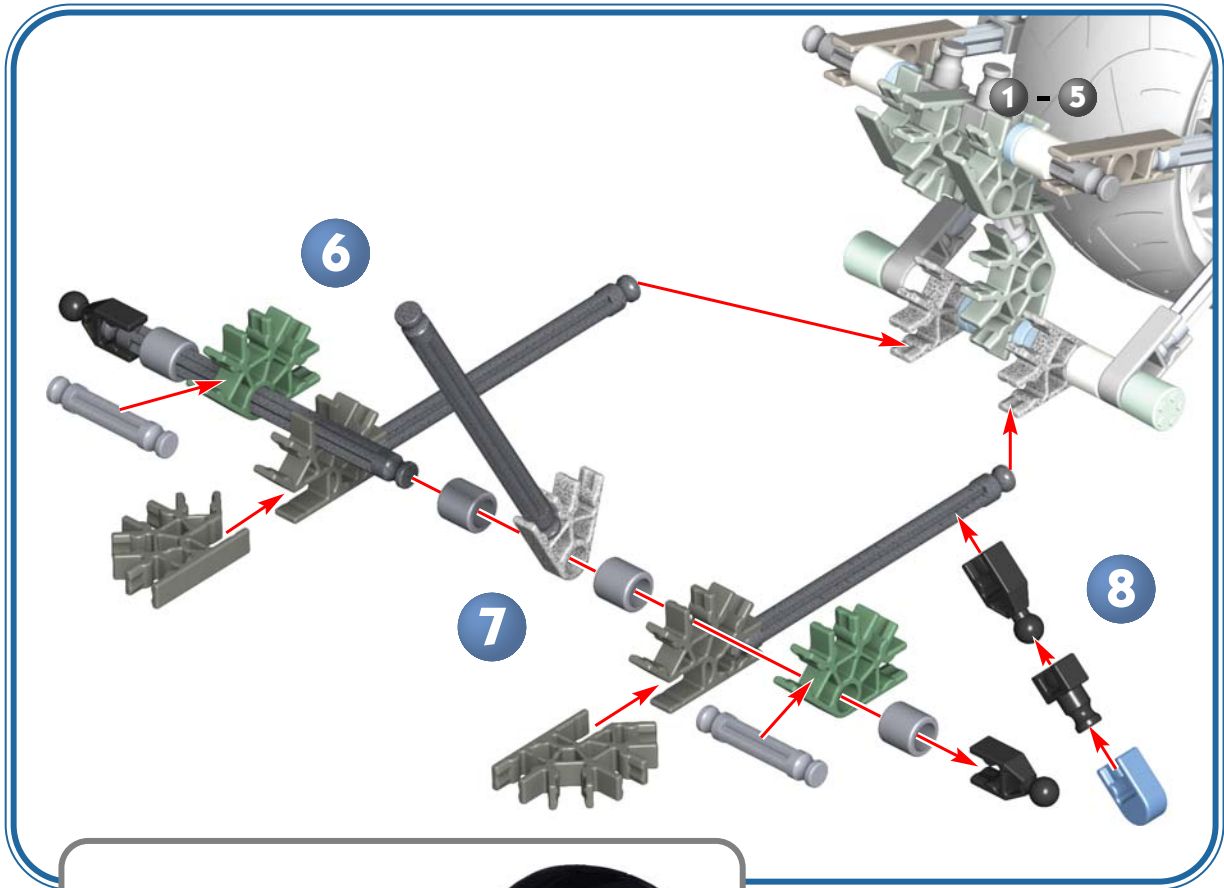

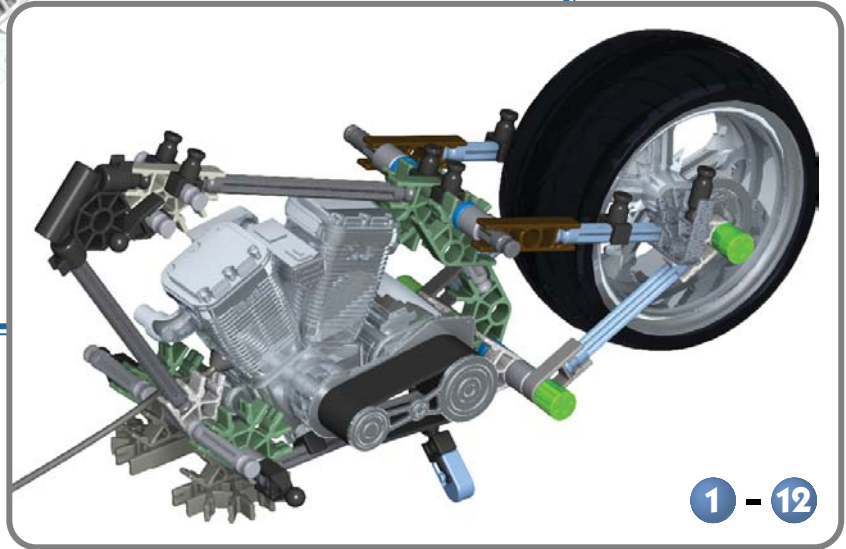
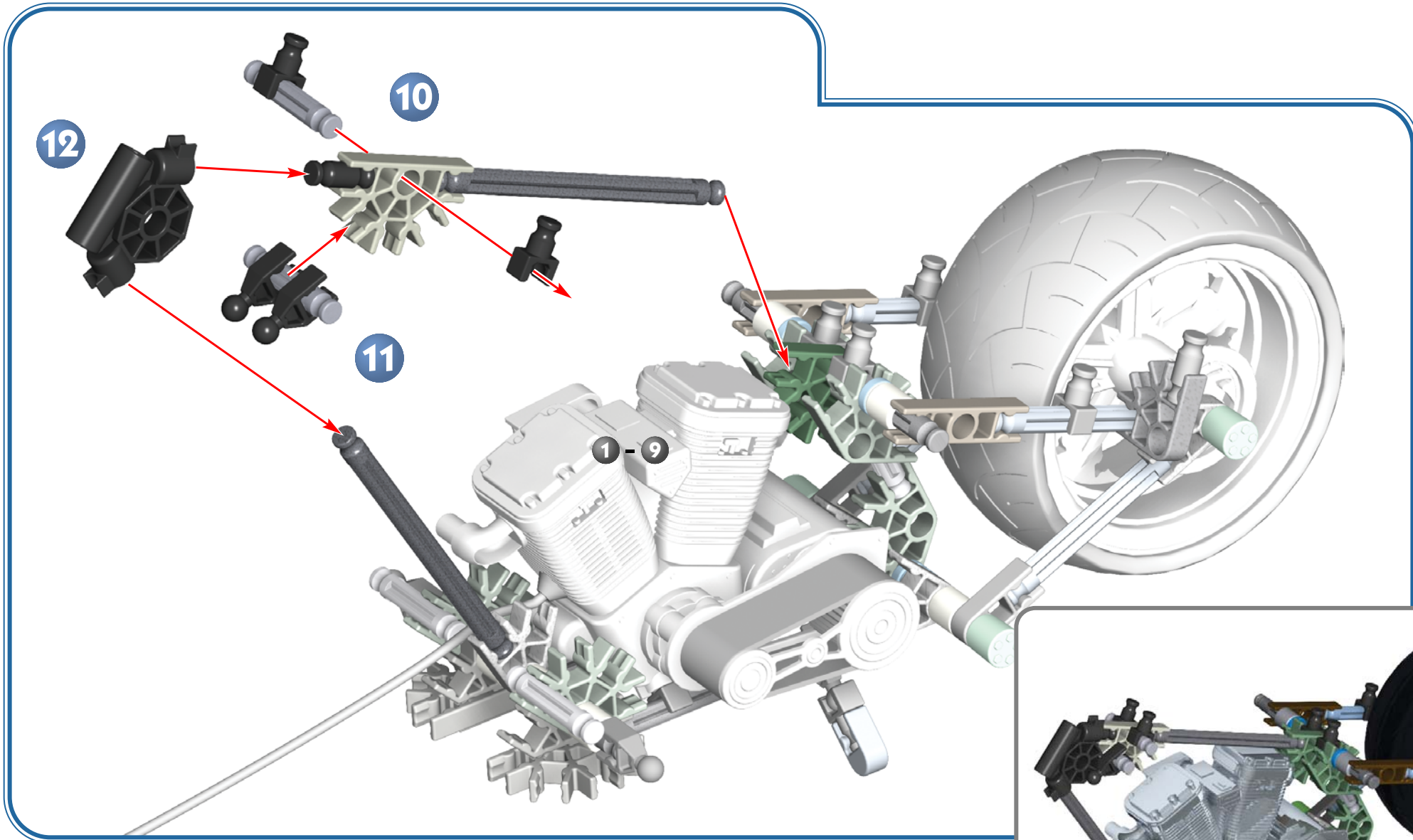

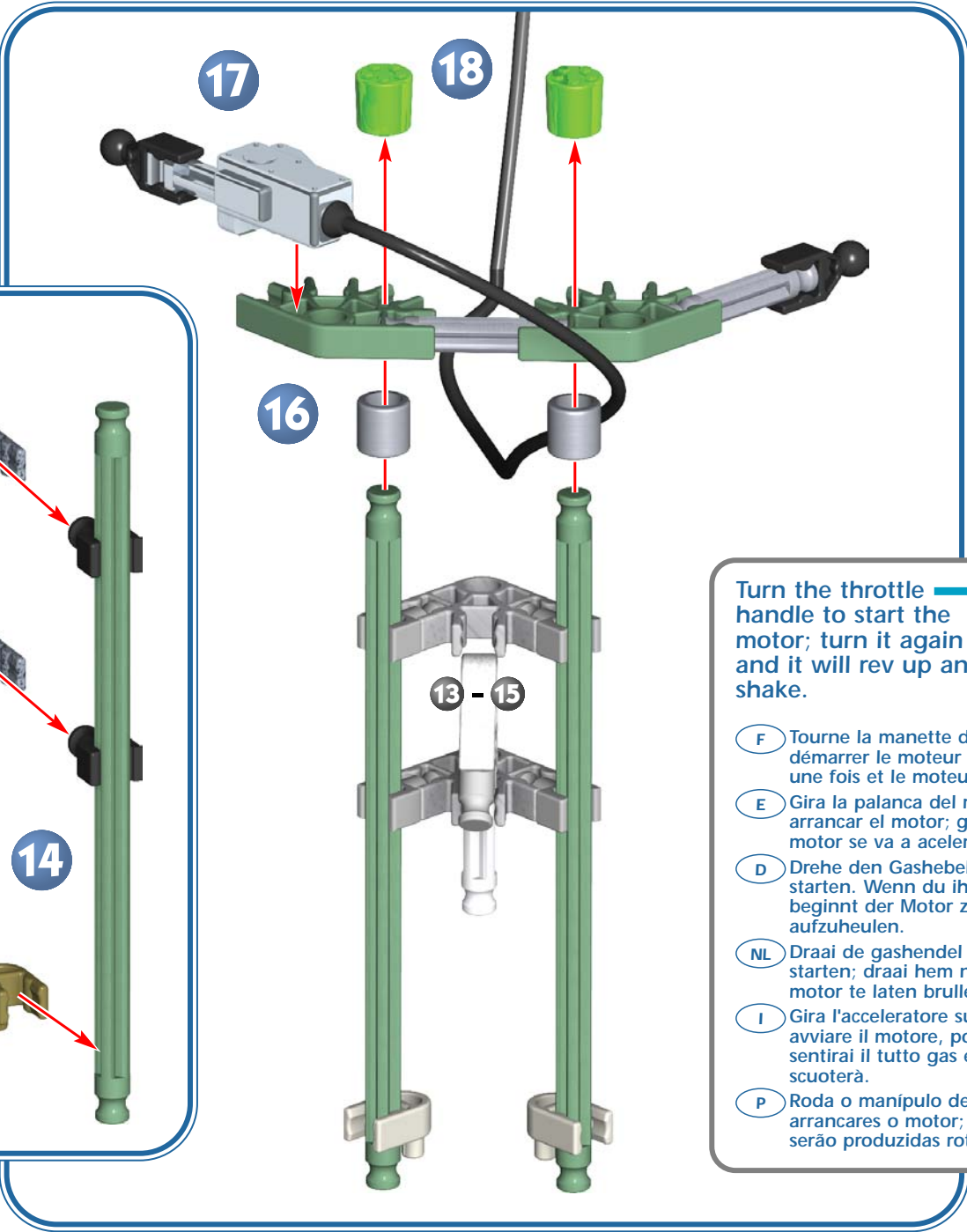
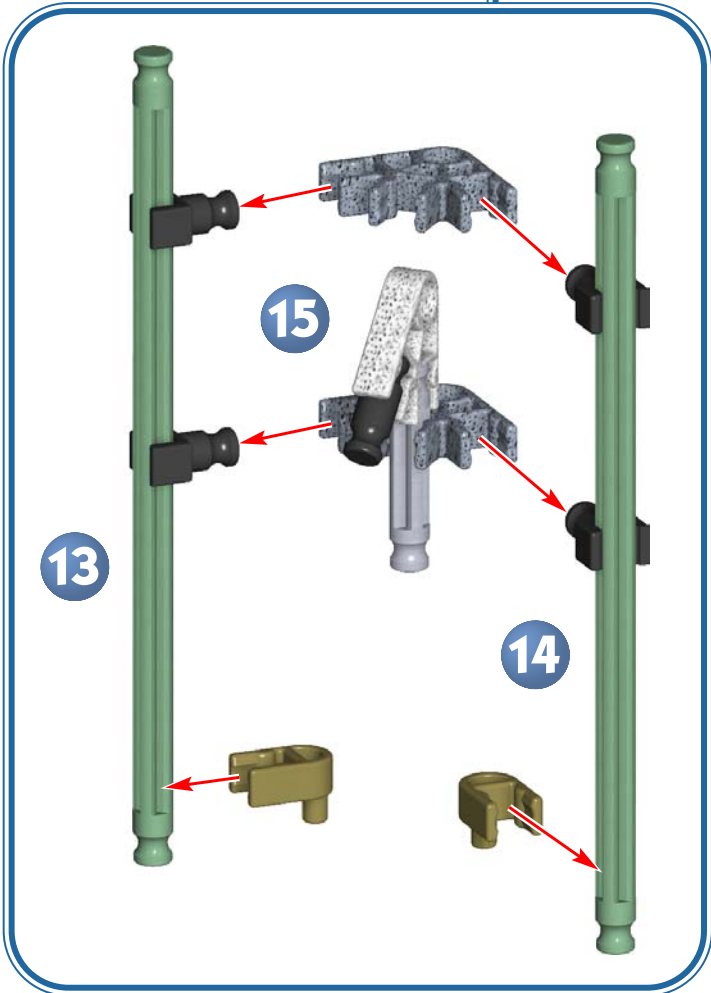

Turn the throttle handle to start the motor; turn it again and it will rev up and shake.

- (F) Tourne la manette des gaz pour faire démarrer le moteur ; tourne-la encore une fois et le moteur rugit et vrombit.
- (E) Gira la palanca del regulador para arrancar el motor; girala otra vez y el motor se va a acelerar y sacudir.
- (D) Drehe den Gashebel, um den Motor zu starten. Wenn du ihn erneut drehst, beginnt der Motor zu wackeln und aufzuheulen.
- (NL) Draai de gashendel om de motor te starten; draai hem nog een keer om te motor te laten brullen en schudden.
- (I) Gira l'acceleratore sul manubrio per avviare il motore, poi giralo di nuovo e sentirai il tutto gas e la moto si scuoterà.
- (P) Roda o manipulo de aceleração para arrancares o motor; roda novamente e serão produzidas rotações e vibrações.

13 - 18

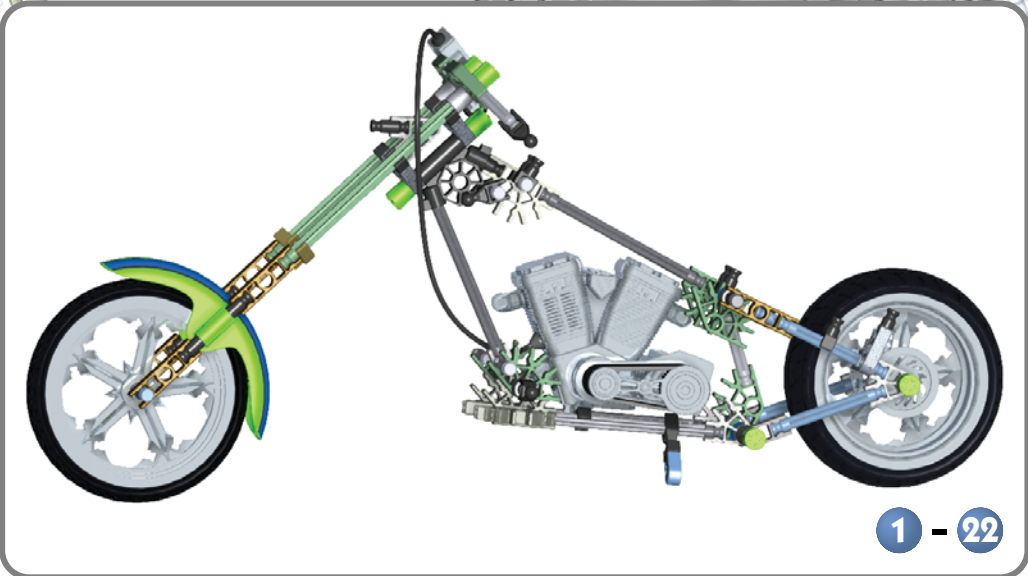
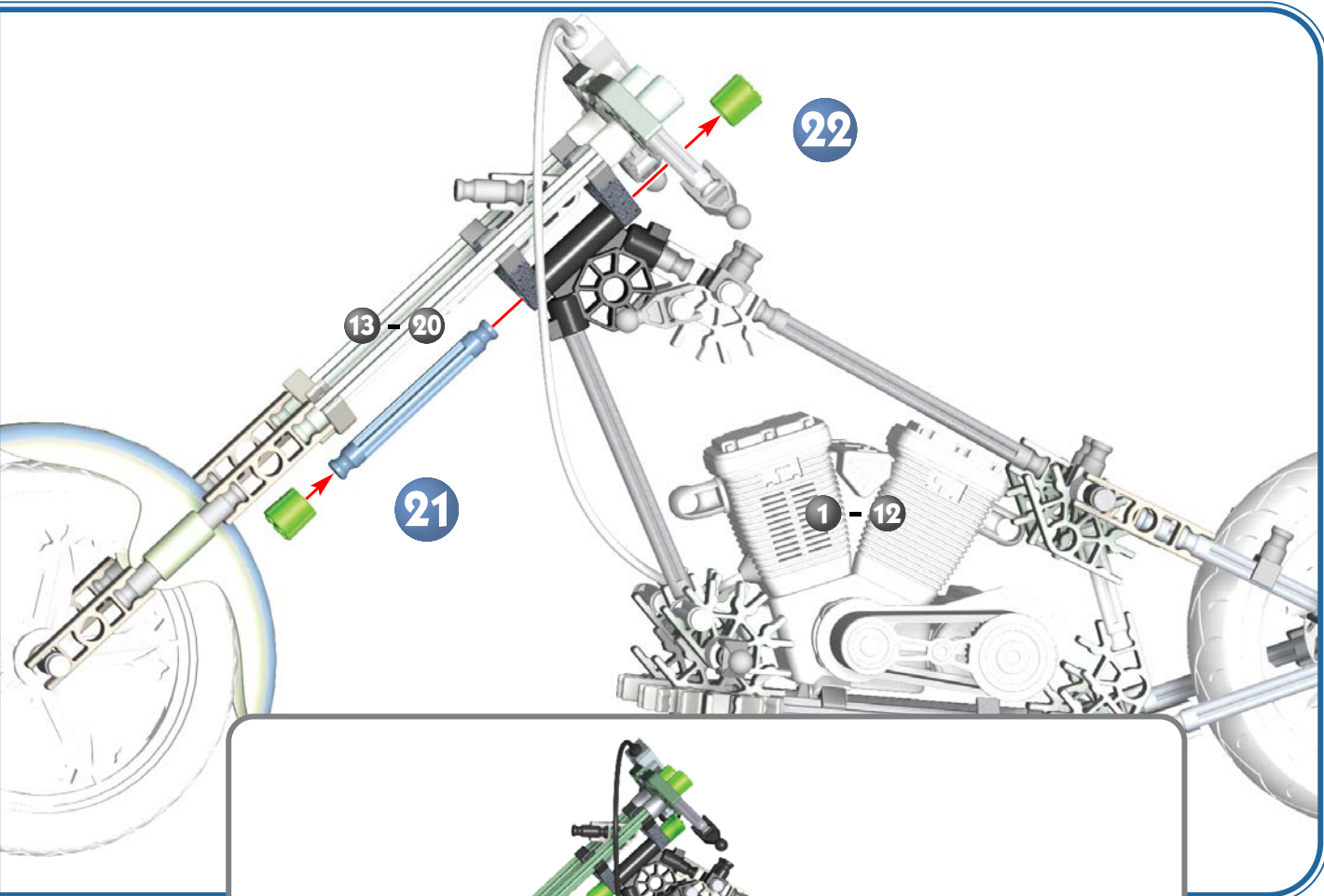
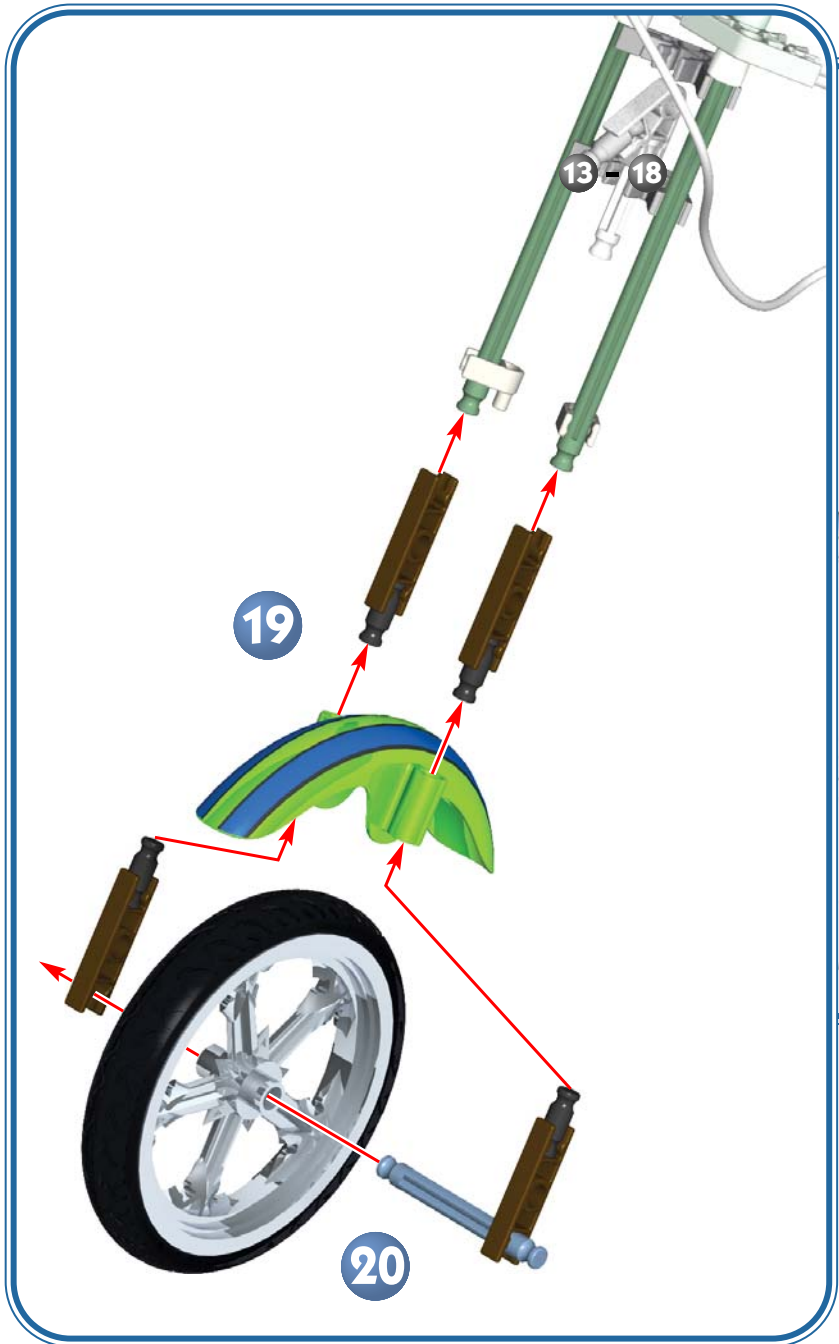

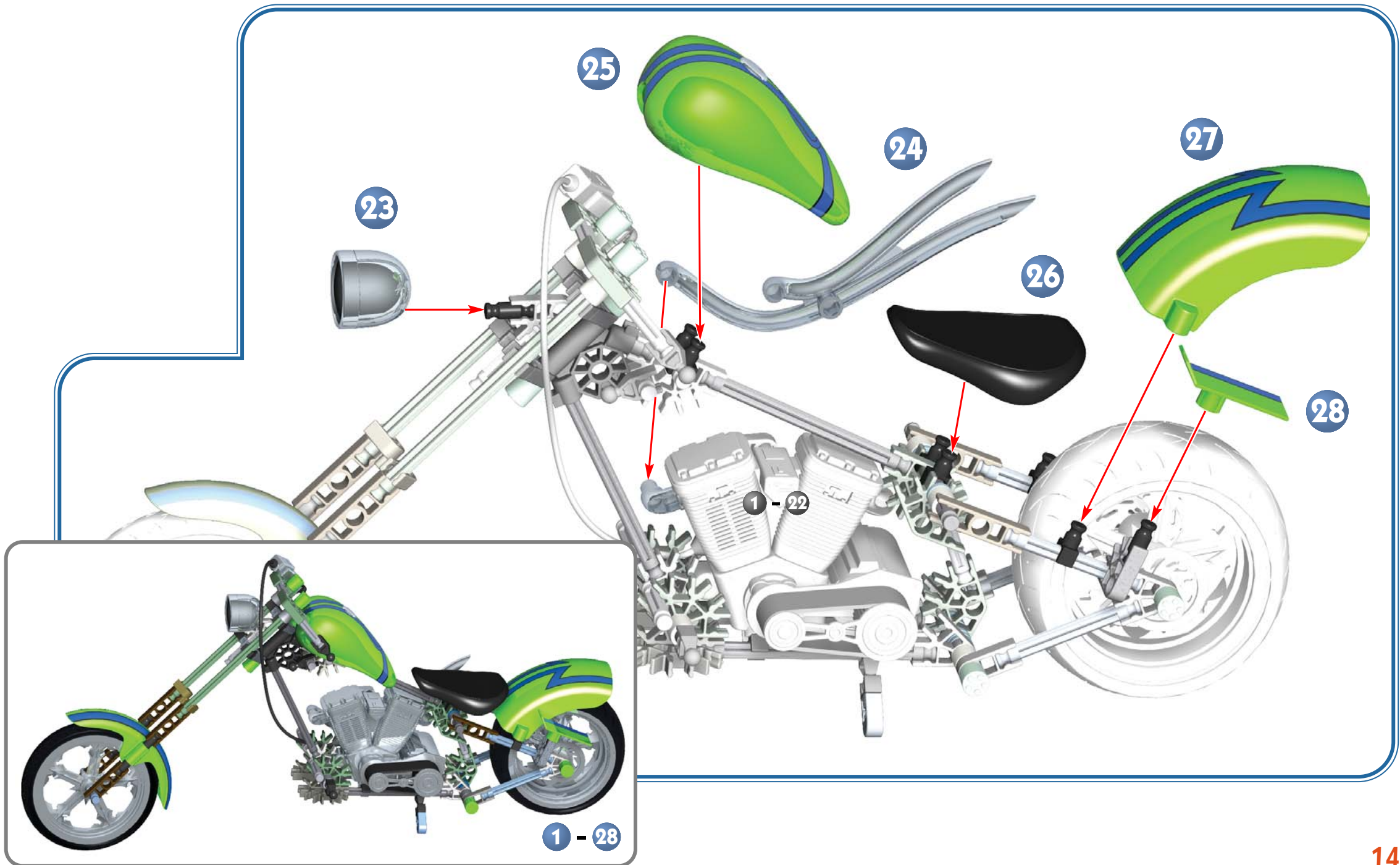

# FRONT-AXLE BIKE

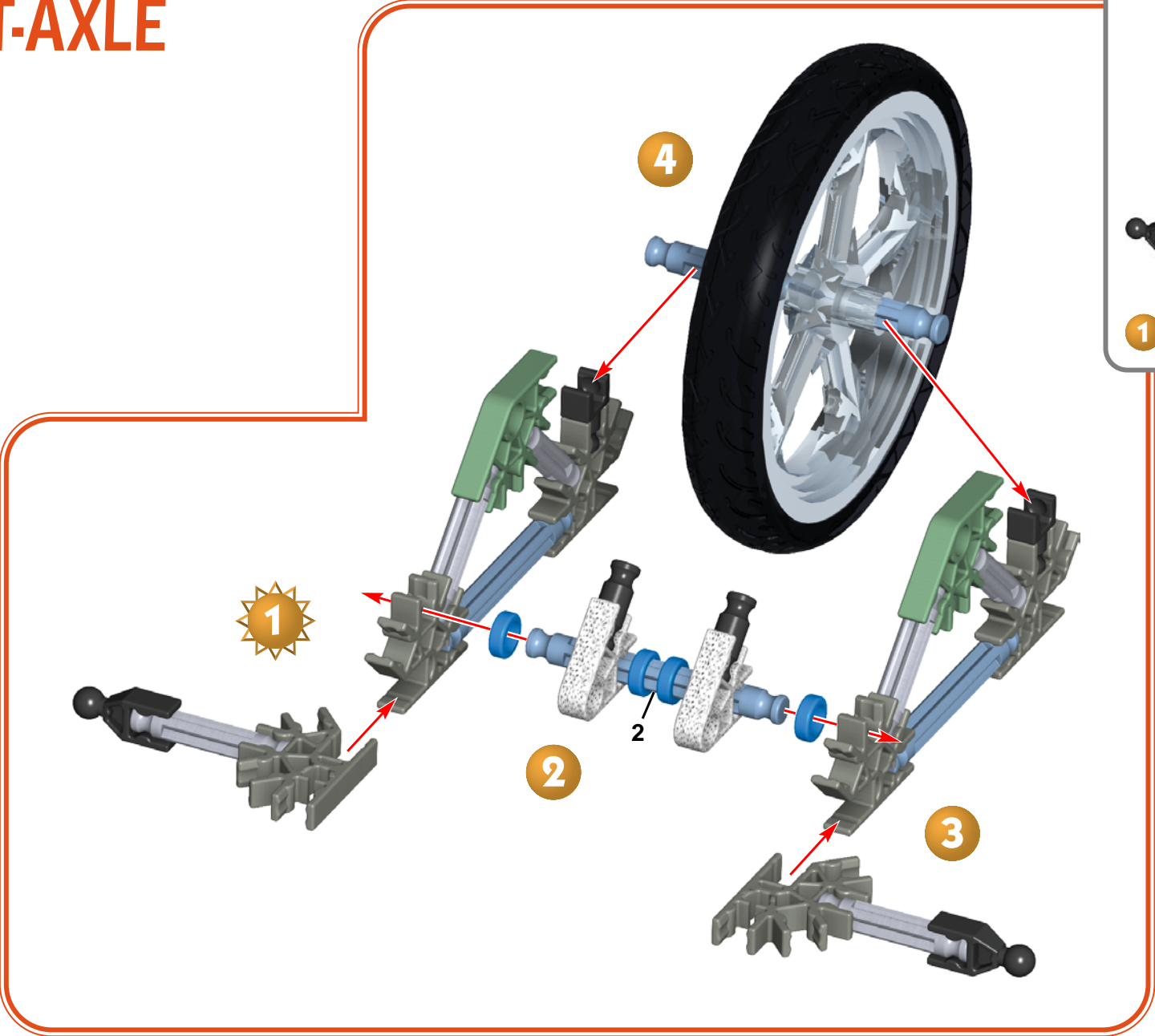

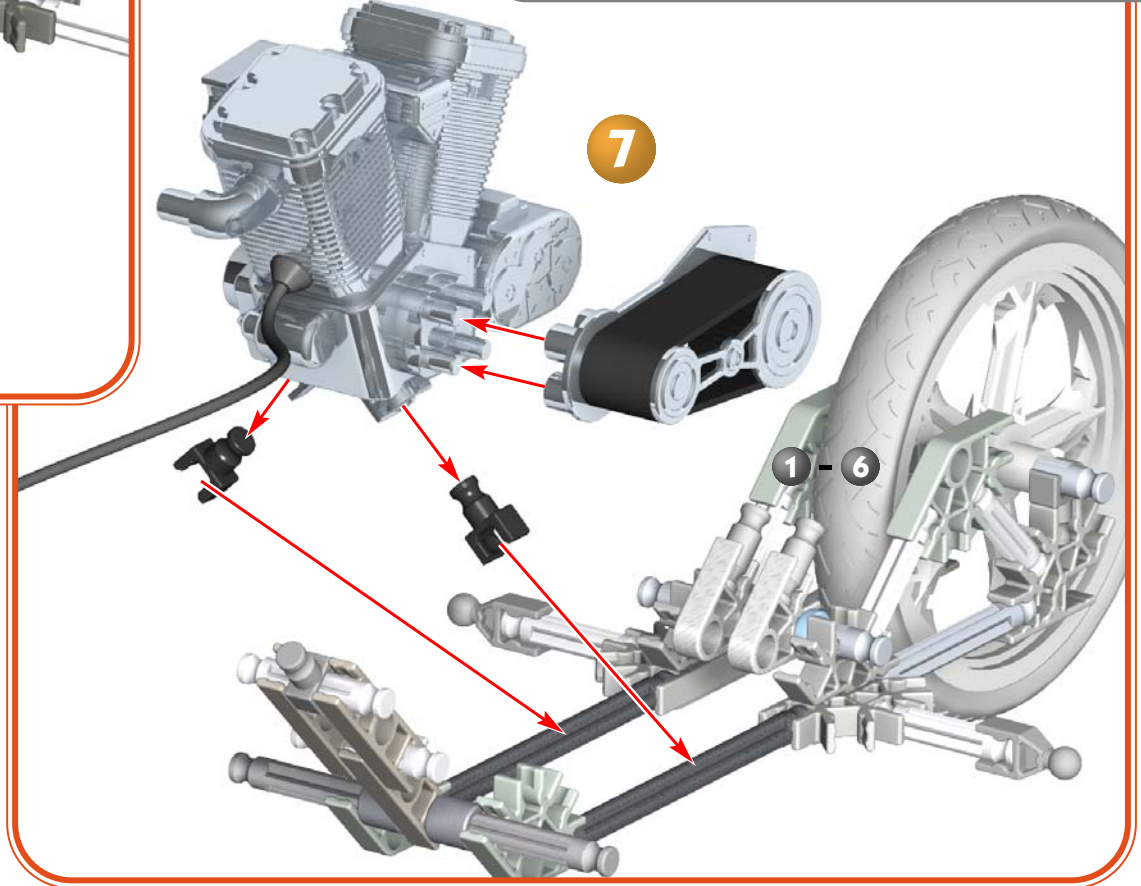
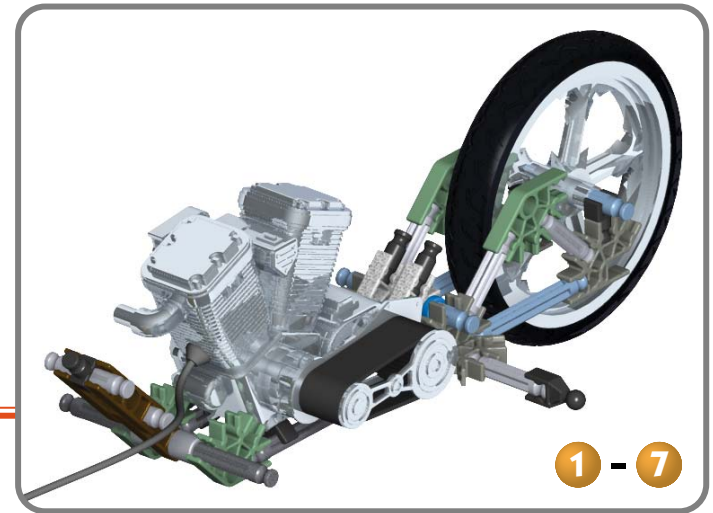
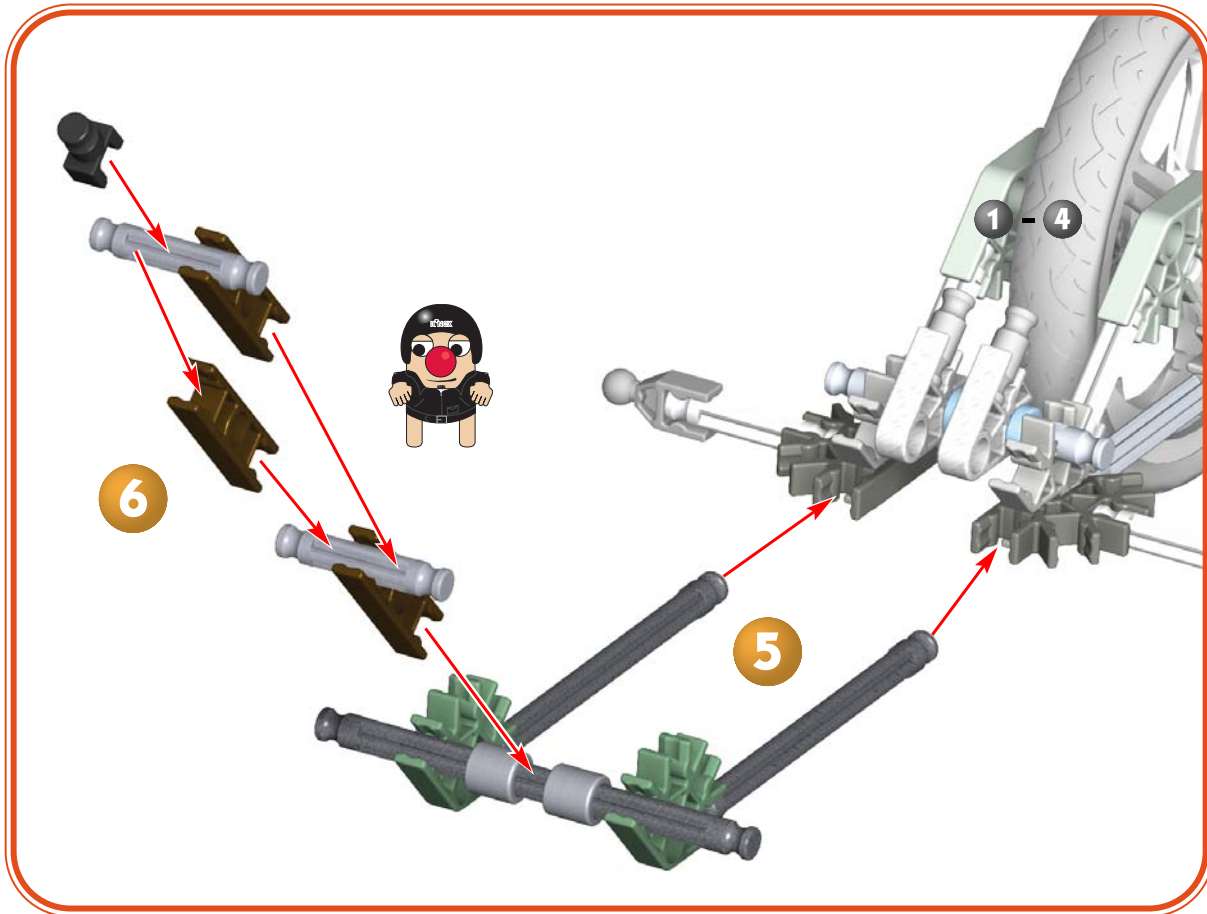

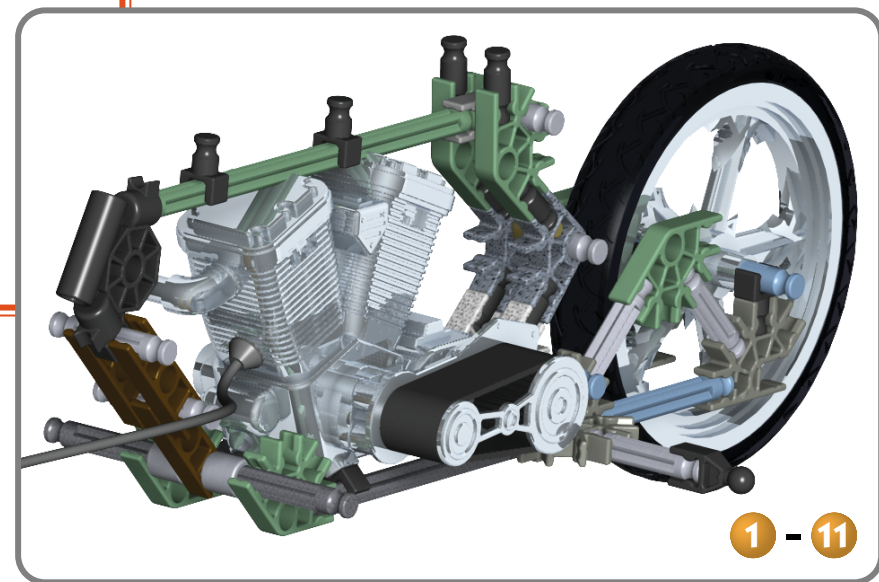
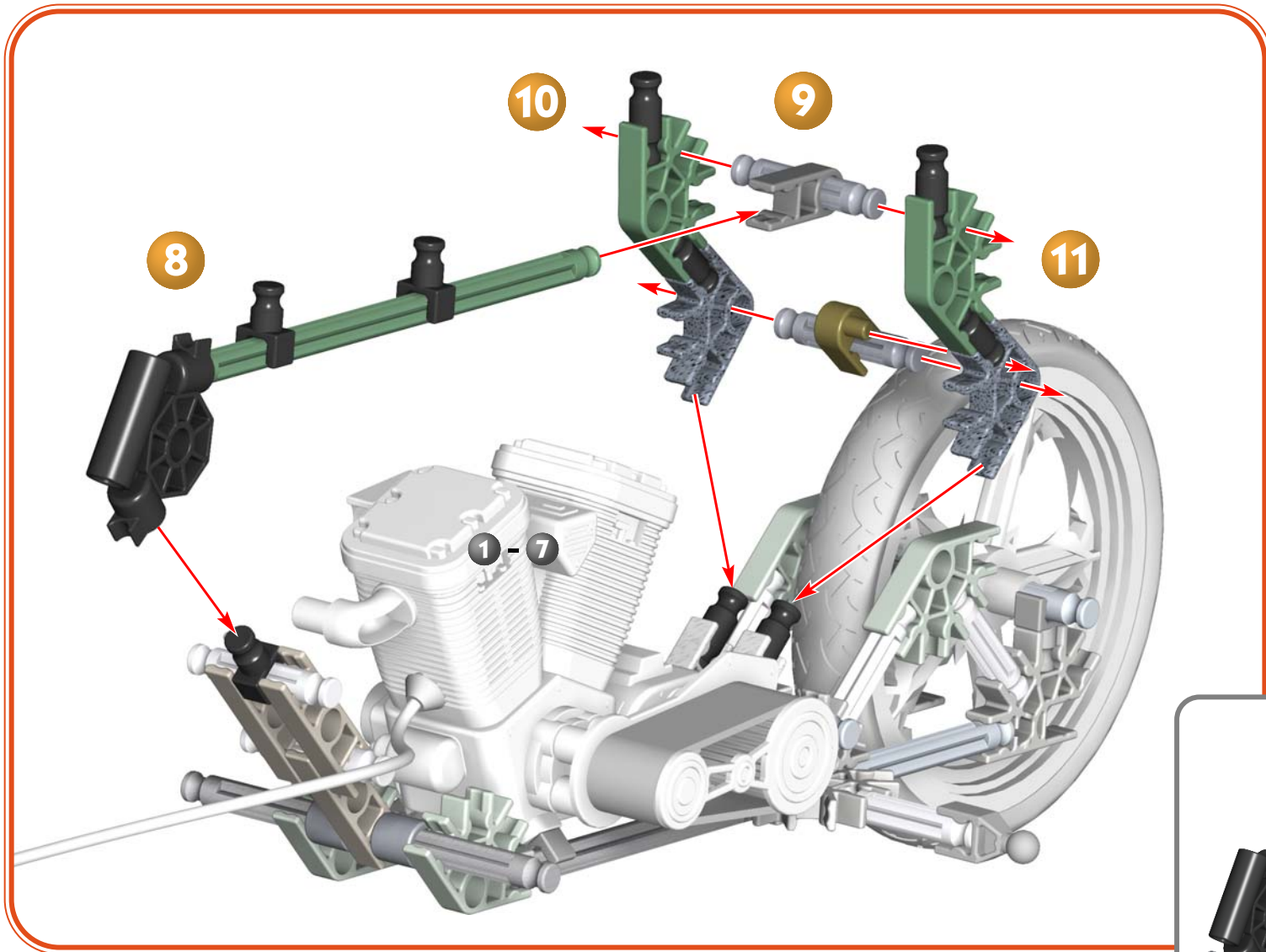

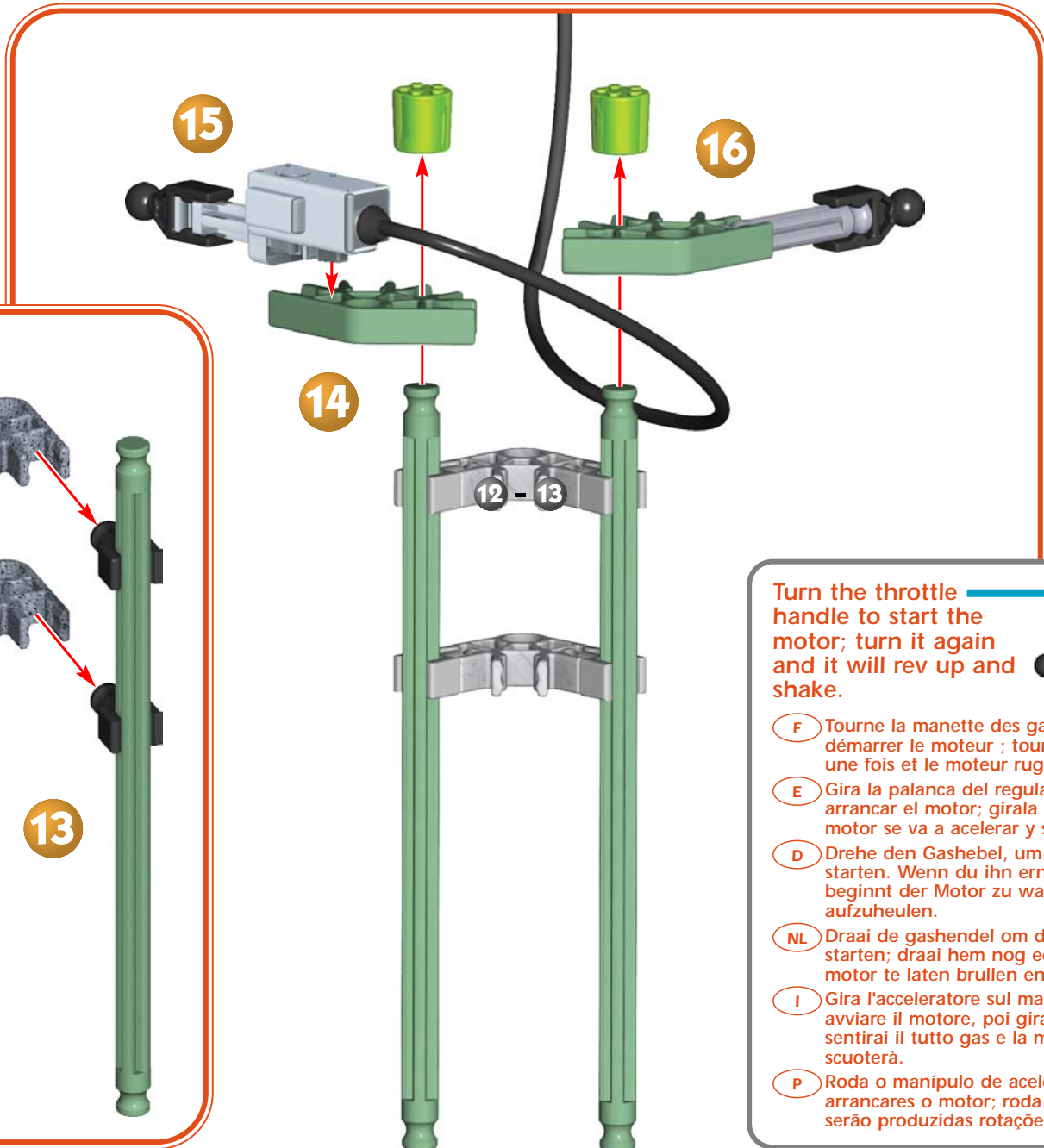
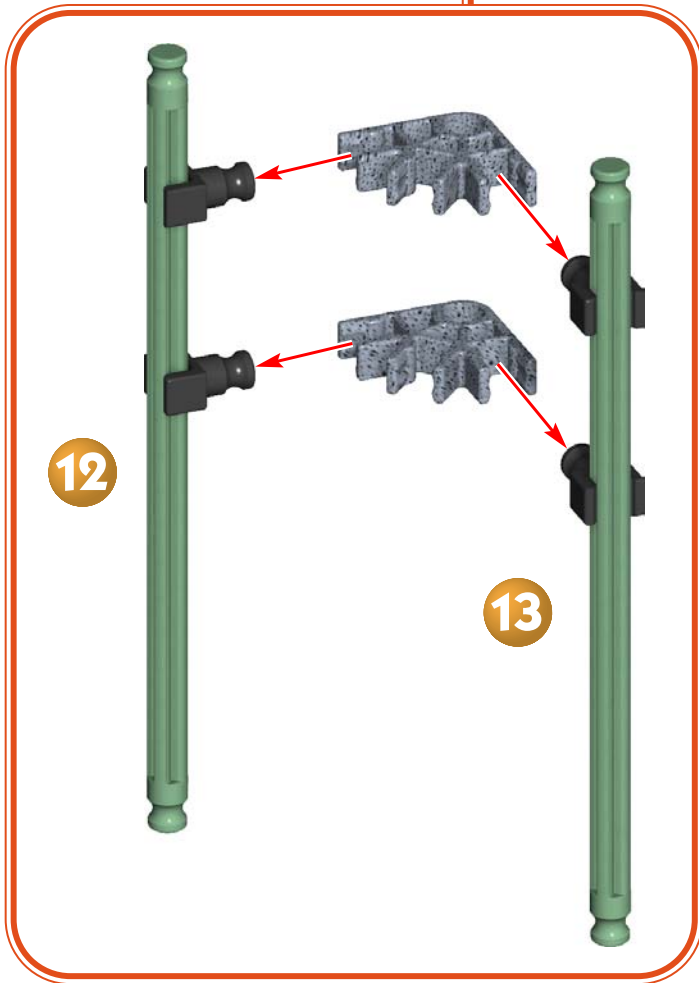

Turn the throttle handle to start the motor; turn it again and it will rev up and shake.

- (F) Tourne la manette des gaz pour faire démarrer le moteur ; tourne-la encore une fois et le moteur rugit et vrombit.
- (E) Gira la palanca del regulador para arrancar el motor; girala otra vez y el motor se va a acelerar y sacudir.
- (D) Drehe den Gashebel, um den Motor zu starten. Wenn du ihn erneut drehst, beginnt der Motor zu wackeln und aufzuheulen.
- (NL) Draai de gashendel om de motor te starten; draai hem nog een keer om te motor te laten brullen en schudden.
- (I) Gira l'acceleratore sul manubrio per avviare il motore, poi giralo di nuovo e sentirai il tutto gas e la moto si scuoterà.
- (P) Roda o manípulo de aceleração para arrancares o motor; roda novamente e serão produzidas rotações e vibrações.

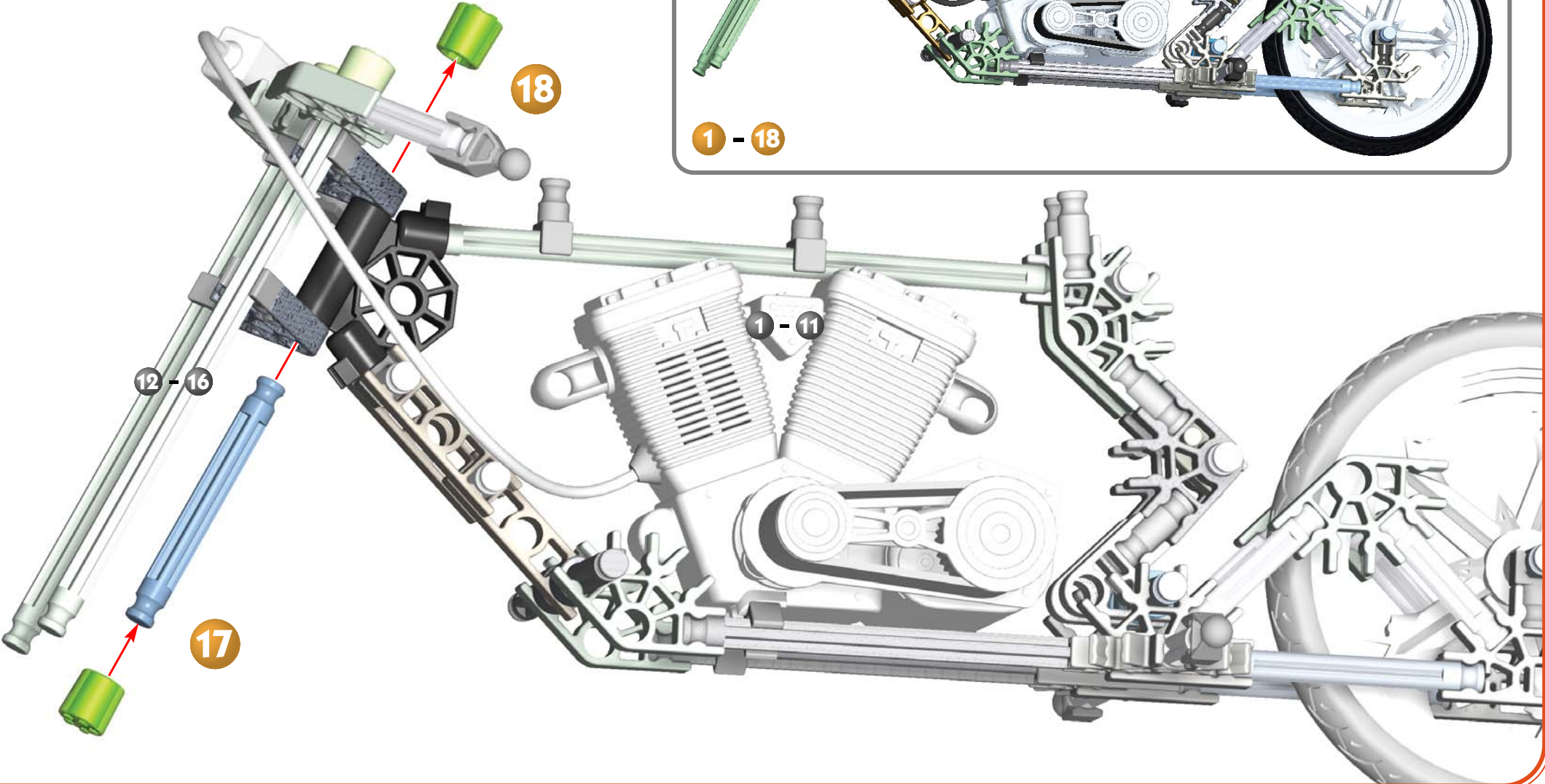
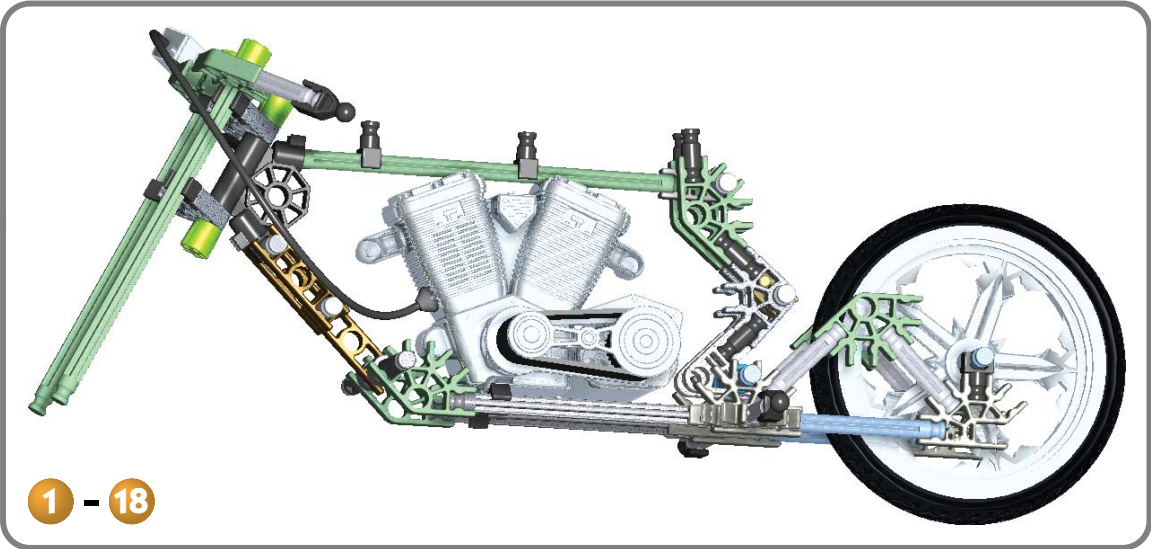

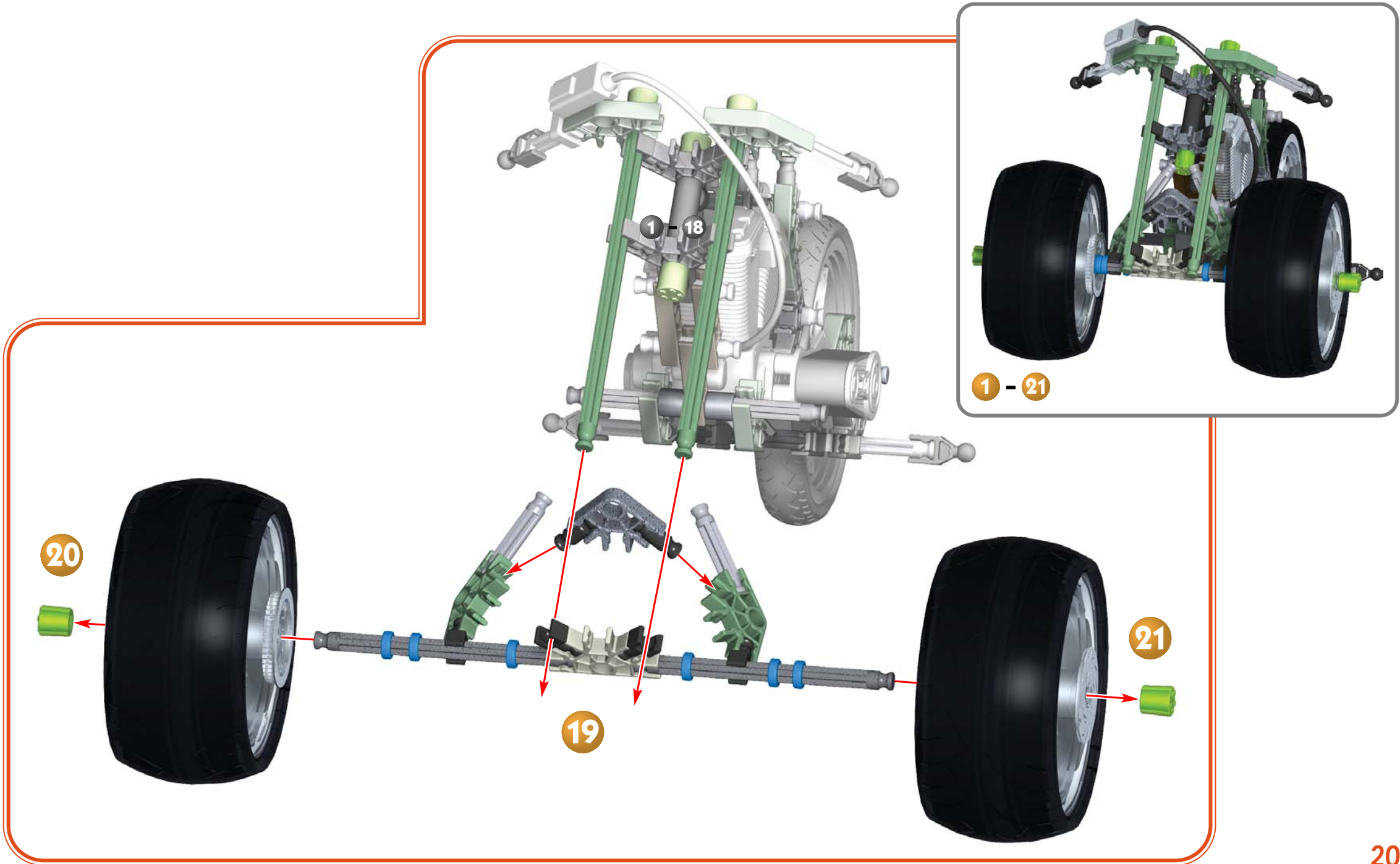

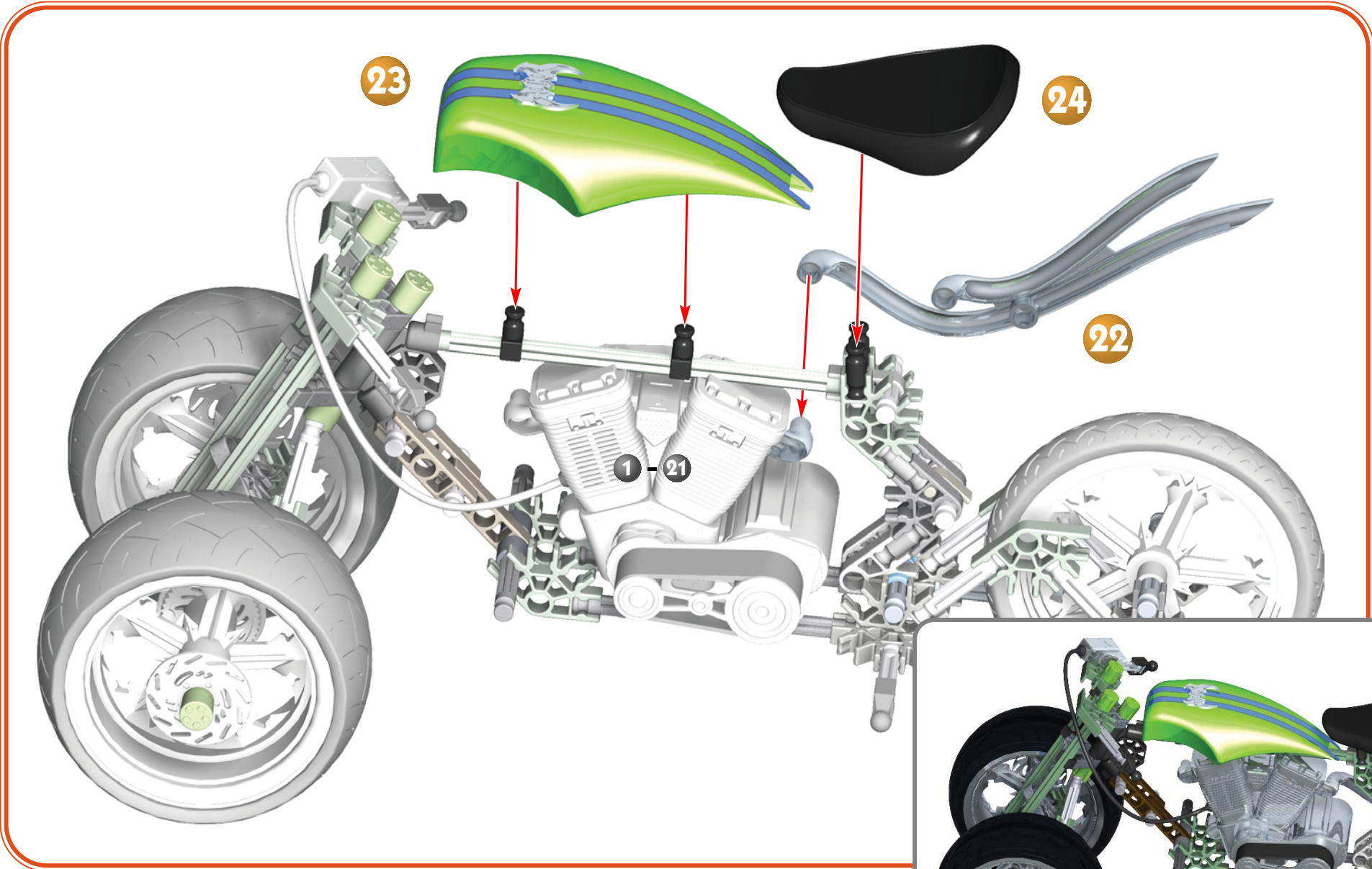



**US** **Consumer Services**  
**K'NEX Industries, Inc.**  
**P.O. Box 700**  
**Hatfield, PA 19440-0700**



**GB** **K'NEX**  
**Newport Consumer Services**  
**Hasbro UK Ltd., Caswell Way**  
**Newport, Gwent NP9 0YH**



**US** **1-800-KID-KNEX**  
**US/Canada only (English only)**

**GB** **00800-22427276 UK/Ireland only**

**F** **E** **D** **NL** **001-215-996-4823**



**email@knex.com**

**Get more, See more, Do more!**  
**Obtiens plus, Vois plus, Fais plus !**



Product and colors may vary.  
 Models can be built one at a time.  
 K'NEX is a registered trademark of K'NEX Industries, Inc.  
 Printed in China.  
 Manufactured under U.S. Patents 5,061,219; 5,137,486; 5,199,919;  
 5,238,438; 5,346,420; 5,350,331; 5,368,514; 5,421,762; 5,423,707;  
 5,427,559; 5,518,435; D383,509; D388,475; D389,203; D391,843;  
 D391,921; D392,555; D403,722; 5,913,706; 6,089,941.  
 Other U.S. and foreign patents pending. Conforms to the  
 Requirements of ASTM Standard Consumer Safety  
 Specification on Toy Safety, F963-03.

Le produit et les couleurs peuvent varier.  
 La plupart des modèles peuvent être construits un à la fois.  
 K'NEX est une marque déposée de K'NEX Industries, Inc.  
 Imprimerie aux China.  
 Fabriqué sous brevets américains 5,061,219; 5,137,486; 5,199,919;  
 5,238,438; 5,346,420; 5,350,331; 5,368,514; 5,421,762; 5,423,707;  
 5,427,559; 5,518,435; D383,509; D388,475; D389,203; D391,843;  
 D391,921; D392,555; D403,722; 5,913,706; 6,089,941.  
 Autres brevets américains et étrangers en  
 instance. Conforme aux spécifications de sécurité  
 du consommateur sur la sécurité des jouets de  
 la norme ASTM F963-03.

©2005 Orange County Choppers® All Rights Reserved.  
 Manufactured by K'NEX Industries, Inc. under  
 license from Orange County Choppers, Inc.  
 J2 Licensing LLC Official Licensing Agents.

©2005 Orange County Choppers® Tous droits réservés.  
 Fabriqué K'NEX Industries, Inc. avec  
 l'autorisation d'Orange County Choppers, Inc.  
 J2 Licensing LLC Official Licensing Agents.

©2005 K'NEX Industries, Inc.  
 P.O. Box 700  
 Hatfield, PA 19440-0700

