

**Standard Mode**  
Modèle Standard#

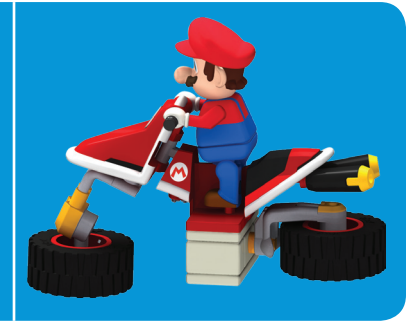

**Hover Mode**  
Mode Flotter:

TM & © 2015 Nintendo.

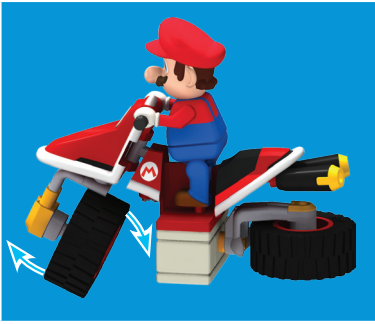

- Identifies Genuine K'NEX Bricks.
- Identifie que ce sont d'authentiques briques K'NEX.
- Identifica los ladrillos genuinos de K'NEX.
- Identifiziert echte K'NEX-Bausteine.
- Edentifica i veri blocchi K'NEX.
- Identifica que são cubos genuinos da K'NEX.
- Identificeert K'NEX bakstenen voor.

#Modo estándar  
Standardmodus  
Modo normale  
Modo padrão  
Standaard toestand

#Modo flotar  
Hover Modus  
Modo per sorvolare  
Modo cursor  
Zweefmodus



facebook.com/knex



**KNEX.COM**

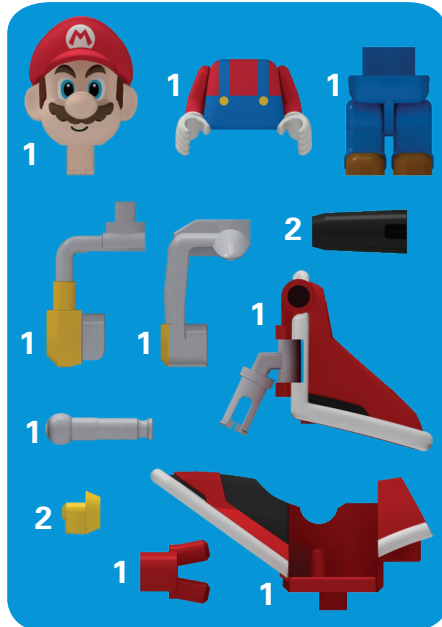
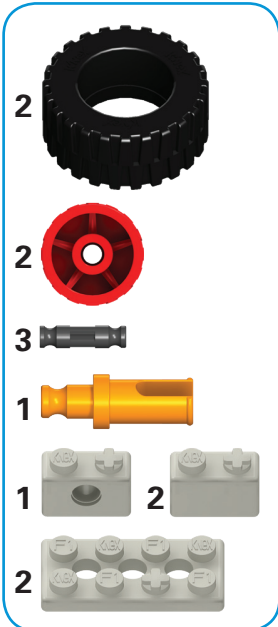

**Sold separately.**  
Vendus séparément.  
Se venden por separado.  
Separat erhältlich.

**Venduti separatamente.**  
Vendidos separadamente.  
Afzonderlijk verkocht.

**WARNING: CHOKING HAZARD** – Small parts. Not for children under 3 years.  
**ATTENTION : RISQUE D'ÉTOUFFEMENT** – Pièces de petite taille. Ne convient pas aux enfants de moins de 3 ans.  
**ADVERTENCIA: PELIGRO DE ASFIXIA** – Piezas pequeñas. No para niños menores de 3 años.  
**ACHTUNG: ERSTICKUNGSGEFAHR** – Kleinteile. Nicht geeignet für Kinder unter 3 Jahren.  
**AVVISO: PERICOLO DI SOFFOCARE** – Pezzi piccoli. Non adatto per bambini sotto 3 anni.  
**AVISO: PERIGO DE SUFOCAÇÃO** – Peças pequenas. Não se destina a crianças com menos de 3 anos de idade.  
**WAARSCHUWING: INSLIKKINGSGEVAAR** – Kleine onderdelen. Niet geschikt voor kinderen jonger dan 3 jaar.

©2015 K'NEX Limited Partnership Group, P.O. Box 700, Hatfield, PA 19440-0700; 1-800-KID-KNEX (USA/Canada/États-Unis/EE.UU.); email@knex.com; knex.com. K'NEX UK Ltd., P.O. Box 3083, Reading RG1 9YQ, England. K'NEX and Building Worlds Kids Love are registered trademarks of K'NEX Limited Partnership Group. Product and colors may vary. For customers outside the USA/Canada please contact your local distributor at www.knex.com/distributors. (FR) K'NEX et Building Worlds Kids Love sont des marques déposées de K'NEX Limited Partnership Group. Produits et couleurs peuvent varier. Pour les clients en dehors du Canada et des États-Unis, veuillez contacter votre distributeur local que vous pouvez trouver sur www.knex.com/distributors. (ES) K'NEX y Building Worlds Kids Love son marcas registradas de K'NEX Limited Partnership Group. El producto y los colores pueden variar. El cliente que no vive en EE.UU./Canadá se pone en contacto con el distribuidor local. Encuentre la información para el distribuidor local en www.knex.com/distributors.

415494.11-V1-1/15

**MARIO™ BIKE BUILDING SET**  
MOTO JEU DE CONSTRUCTION

**Standard mode**  
Modèle Standard#

**Hover mode**  
Mode Flotter#

**6+** 38494

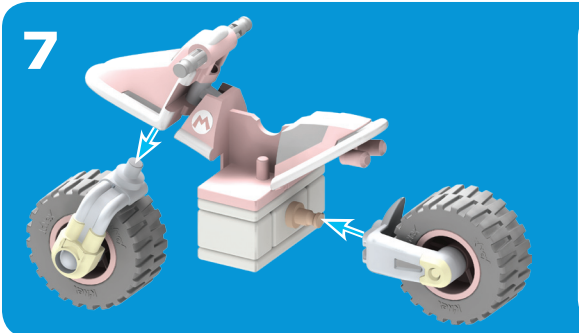
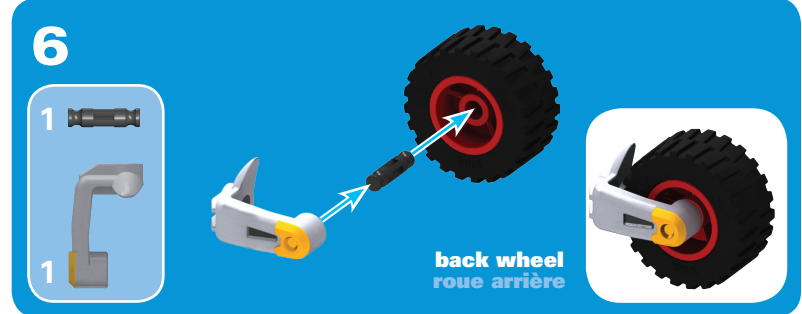
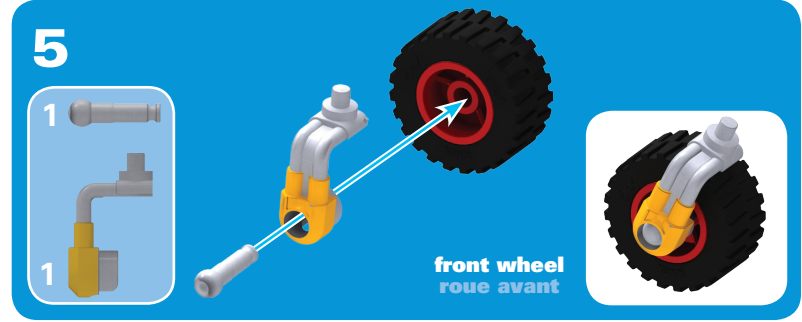
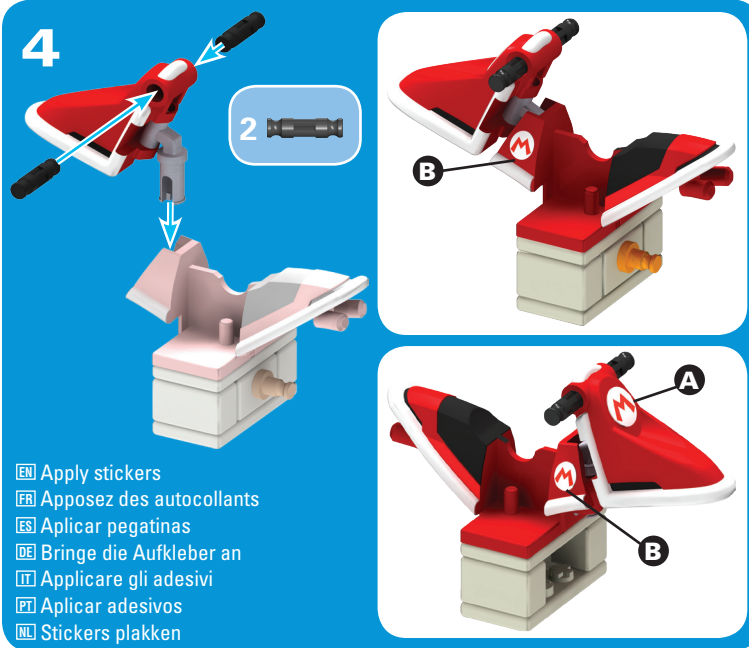
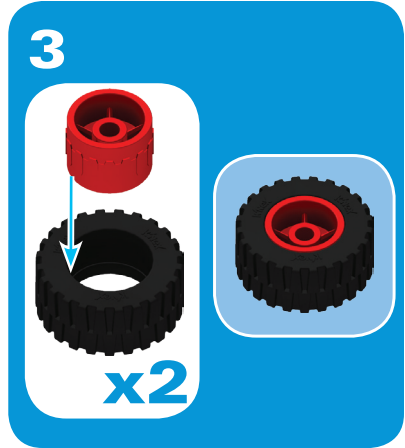
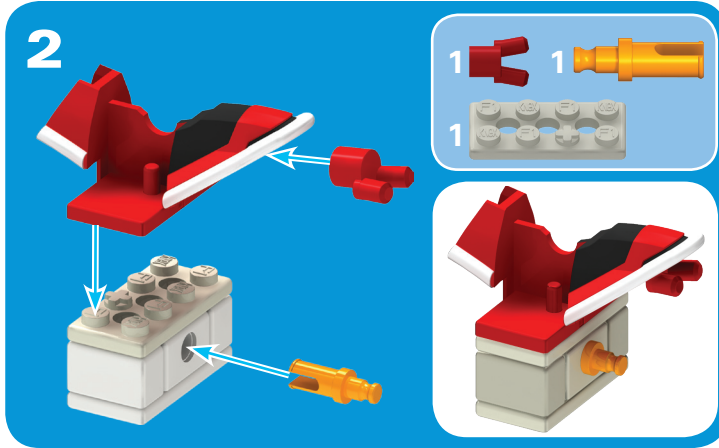
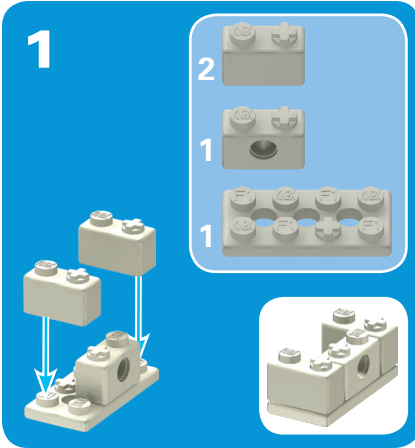

**MARIOKART**

**MARIO™**  
BIKE BUILDING SET  
MOTO JEU DE  
CONSTRUCTION

