

K'NEX building basics:
To begin your model, start here at step 1 and follow the numbers. It helps to face your model in the same direction as the instructions while you build. The arrows show you where the parts connect. The faded color parts are the ones you have already put together.

Notions de base K'NEX pour le montage:
Pour commencer ton modèle, trouve l'étape numéro 1 et suis les numéros. Pour t'aider pendant que tu construis, oriente ton modèle dans le même sens que les instructions. Les flèches t'indiquent où les pièces s'assemblent, mais les points de raccordement n'ont pas tous des flèches. Les pièces de couleur délavée sont celles que tu as déjà assemblées.

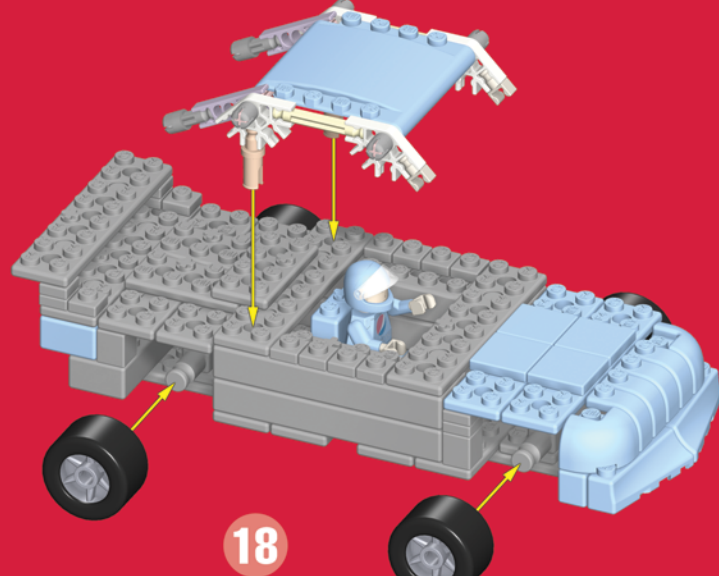
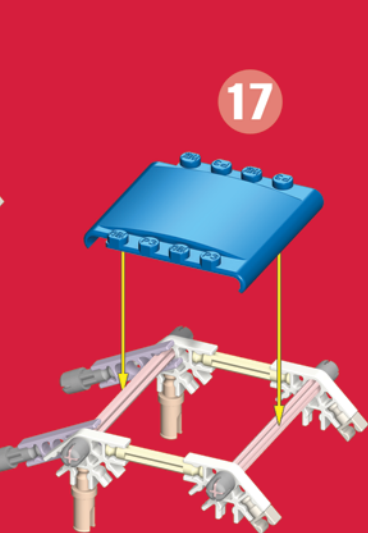
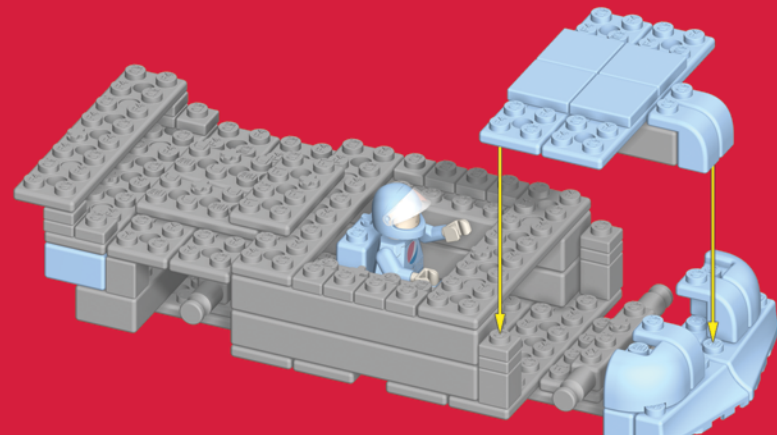
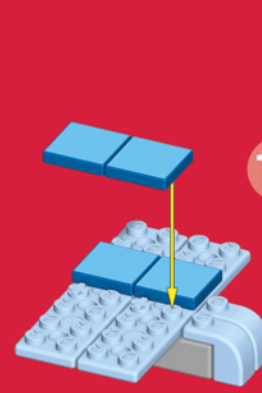
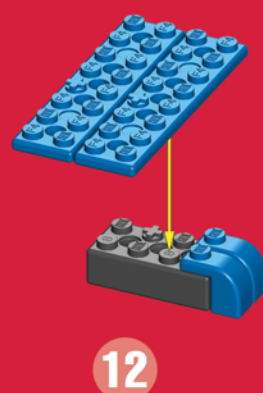
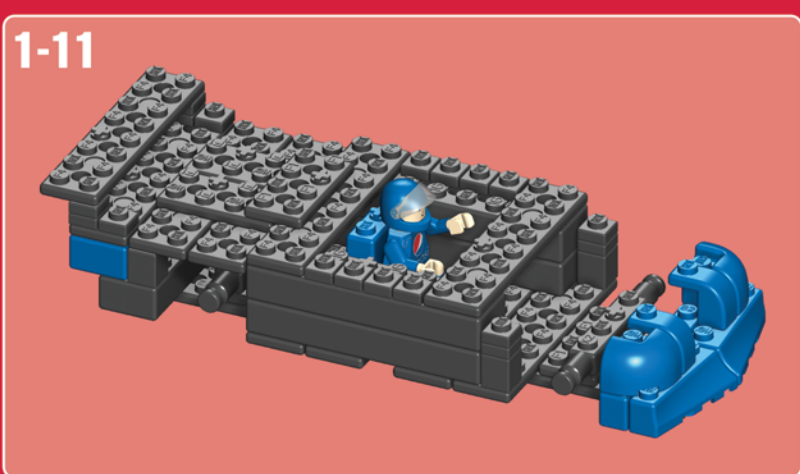
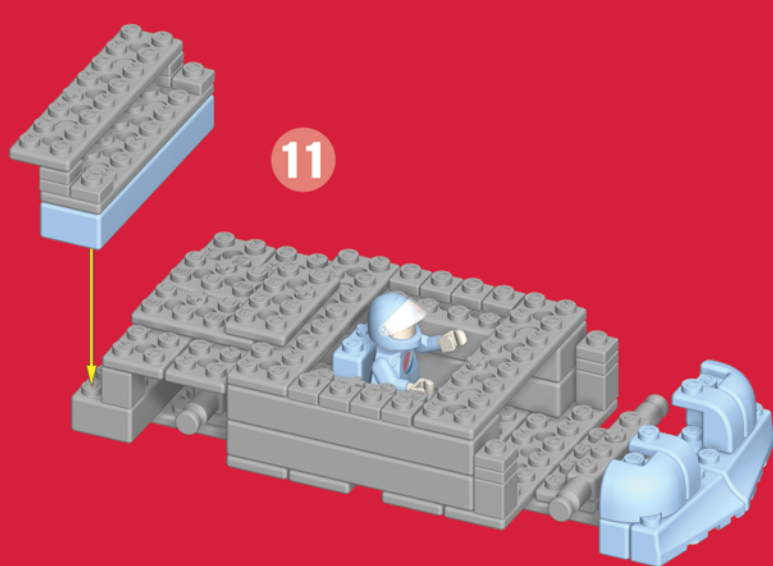
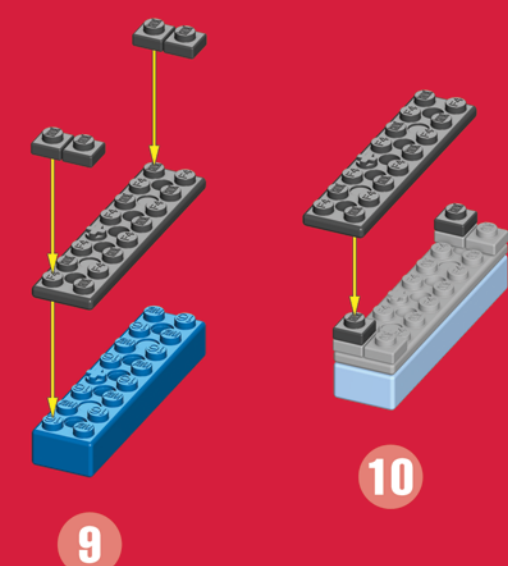
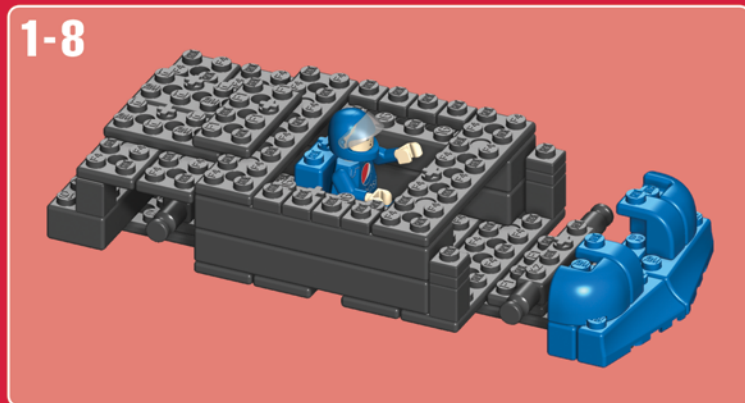
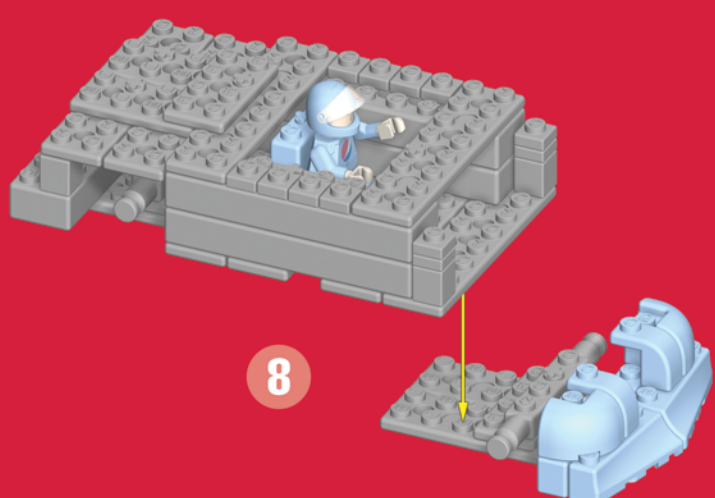
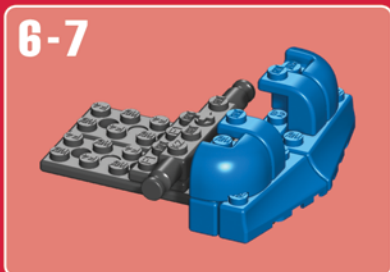
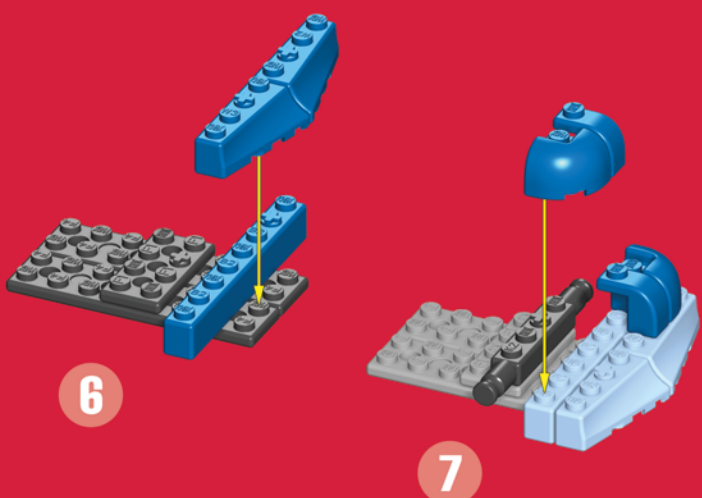
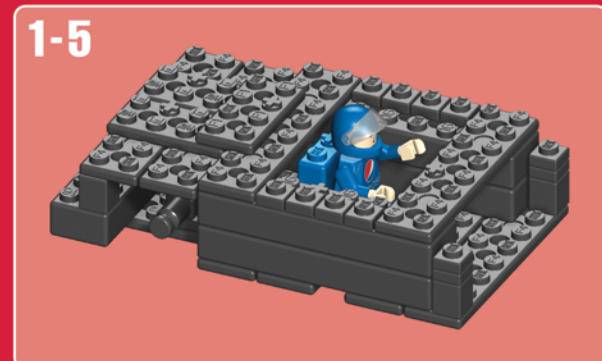
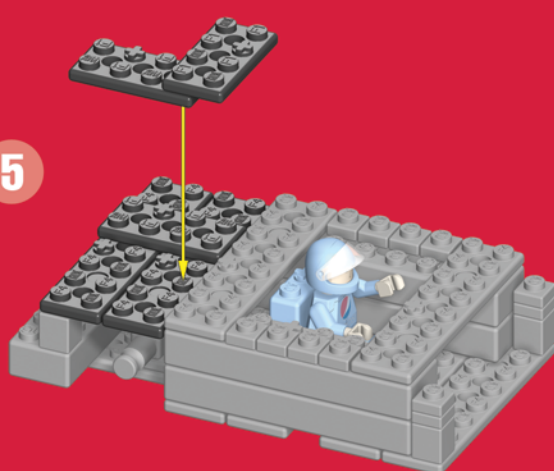
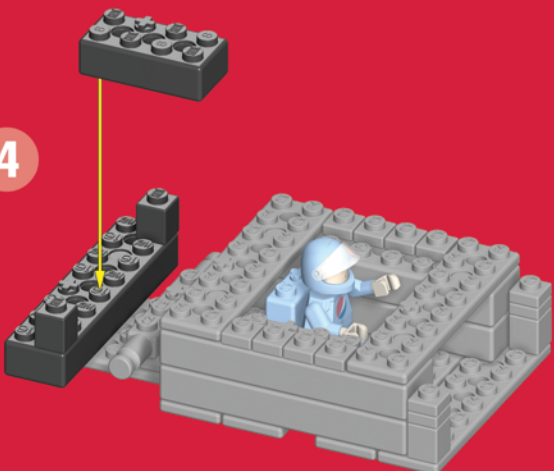
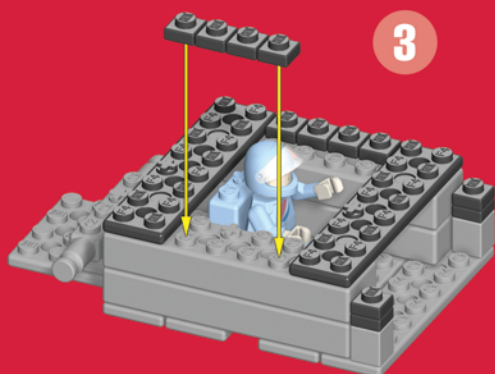
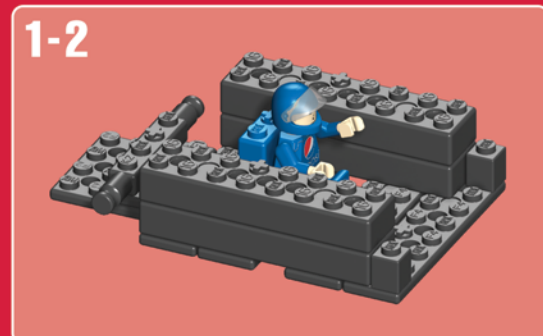
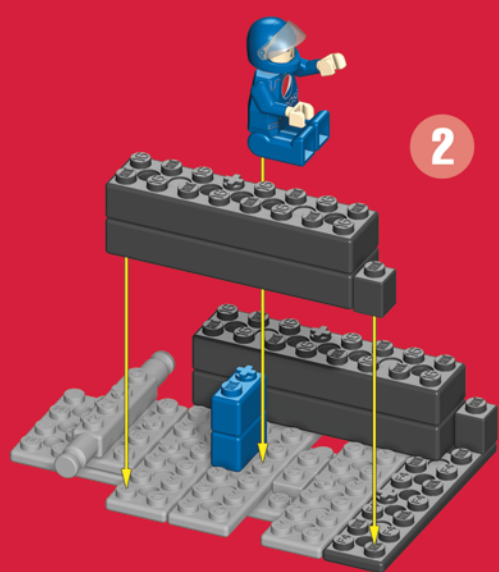
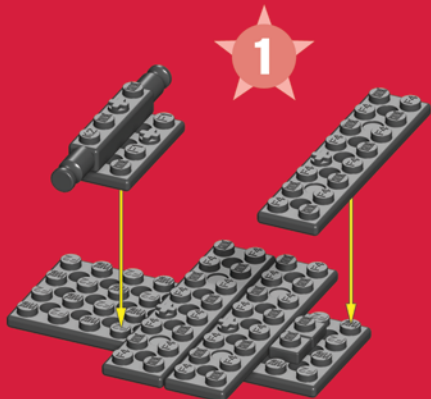
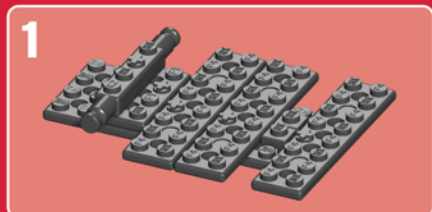

WARNING: CHOKING HAZARD - Small parts. Not for children under 3 years.

AVERTISSEMENT: DANGER D'ÉTOUFFEMENT - Pièces de petite taille. Ne pas donner aux enfants de moins de 3 ans.

1-800-KID-KNEX
©2009 K'NEX Limited Partnership Group
P.O. Box 700
Hatfield, PA 19440-0700

K'NEX is a registered trademark of K'NEX Limited Partnership Group. Product & colors may vary. Most models can be built one at a time. Manufactured under U.S. Patents/Fabriqué sous brevets américains/Fabricado bajo patentes de EE.UU. 5,061,219; 5,199,919; 5,350,331; 7,267,598; D553,204; D393,417; D550,785. Other U.S. and foreign patents pending. Autres brevets américains et étrangers en instance. Otras patentes de EE.UU. y países extranjeros pendientes. Community design no. Le dessin ou modèle communautaire/Número de diseño de comunidad 000 645338-001-0002. (FR) K'NEX est une marque déposée de K'NEX Limited Partnership Group. Produits et couleurs peuvent varier. La plupart des modèles ne peuvent être construits que un à un. (ES) K'NEX es una marca registrada de K'NEX Limited Partnership Group. El producto y los colores pueden variar. La mayoría de los modelos se puede construir uno a la vez. Otras patentes de EE.UU. y países extranjeros pendientes.

K'NEX

136001-V2-09/09

Sold separately.
Vendus séparément.
Se venden por separado.

88



©2009 HGL, LLC. The name, likeness and signature of Jeff Gordon and the likeness of the DuPont/Pepsi Chevrolet are used under license granted by HGL, LLC.
NASCAR® is a registered trademark of the National Association for Stock Car Auto Racing, Inc. Le nom, la ressemblance et la signature de Jeff Gordon et de la ressemblance du DuPont/Pepsi Chevrolet sont utilisées conformément à la licence accordée par HGL, LLC.
NASCAR® est une marque inscrite de l'Association nationale pour Stock Car Auto Racing, Inc.

Identifiez Genuine K'NEX Bricks.
Identifiez ce qui sont d'authentiques briques K'NEX.
Identifica los ladrillos genuinos de K'NEX.
Identifiziert echte K'NEX-Bausteine.
Identifica i veri blocchi K'NEX.
Identifica que são cubos genuinos da K'NEX.
Identificeert K'NEX bakstenen voor.



NASCAR 24 PEPSI CAR BUILDING SET™



Jeff Gordon



Follow these pictures when you are ready to put the labels on the car.

Utilisez ces graphiques quand vous êtes prêts à appuyer sur ces designs sur votre modèle.

Use estos cuadros cuando usted está listo a presionar estos diseños a los lados del modelo.

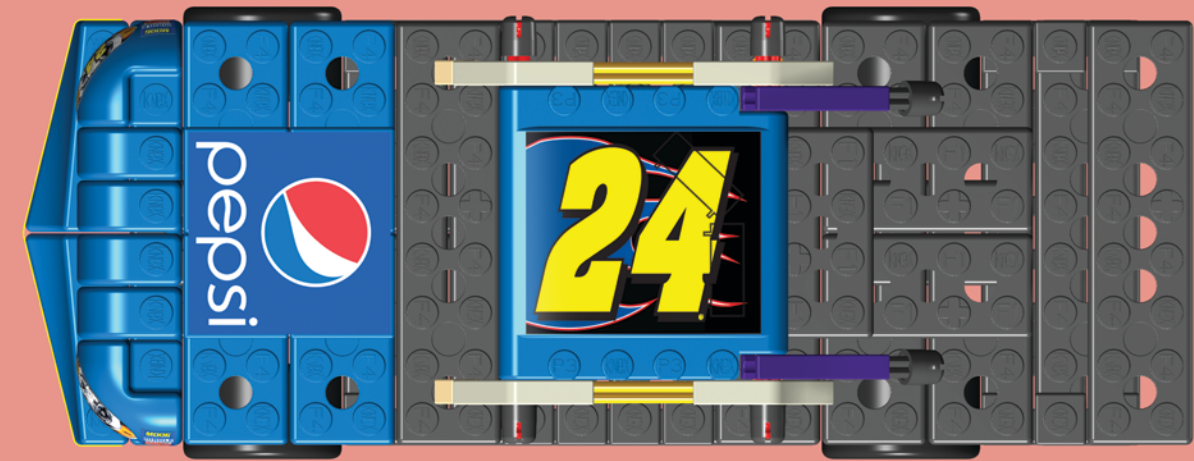
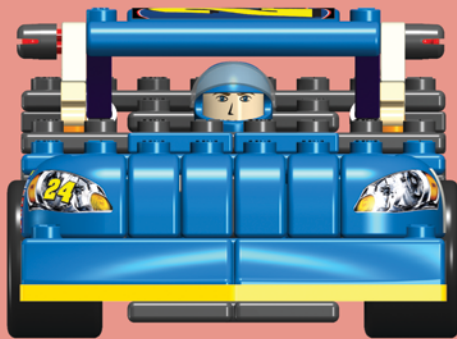

Parts List. Liste des pièces. Lista de piezas.

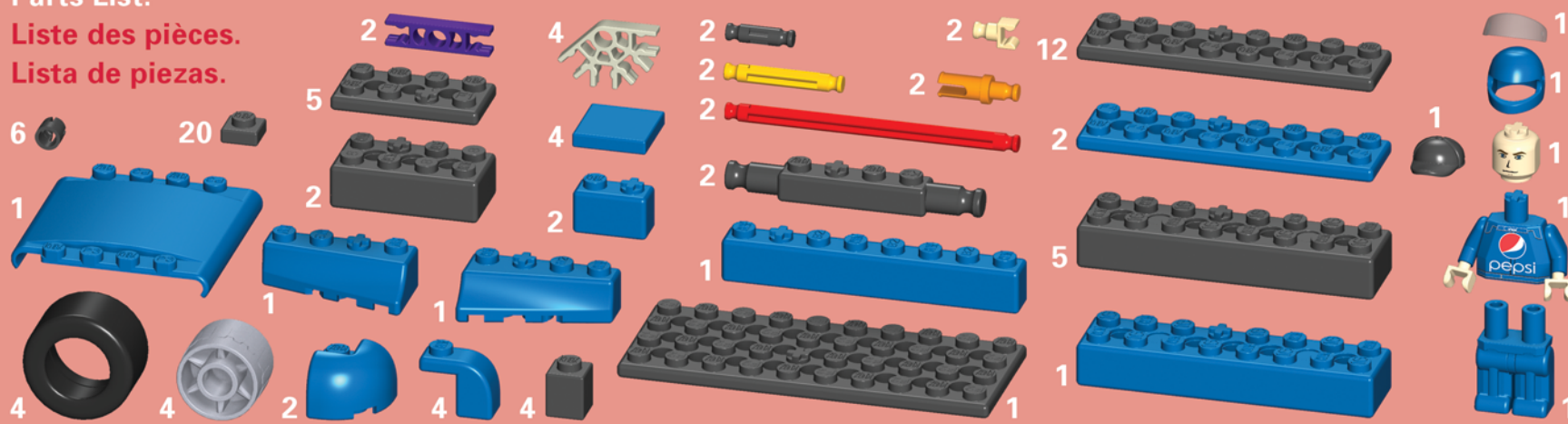

KNEX.COM

For building help, updates to instructions or other great building ideas log on to www.knex.com/racing.
Pour l'aide, les mises à jour aux instructions ou à d'autres jouets vont à www.knex.com/racing.
Para la ayuda, las actualizaciones a instrucciones u otros juguetes van a www.knex.com/racing.

