

HI-FLYERS™



Visit www.knex.com/instructions and enter code 11630 to find instructions for these models.

Visite www.knex.com/instructions et entre le code 11630 pour trouver des instructions pour ces idées de jouet.

Visitar www.knex.com/instructions y entrar el código 11630 para buscar instrucciones para estas ideas de juguete.
 Besuche www.knex.com/instructions gib den code 11630 ein, um eine Anweisung für diese Spielideen zu erhalten.
 Visita www.knex.com/instructions e immetti il codice 11630 per trovare le istruzioni per queste idee di giochi.
 Visita a www.knex.com/instructions e introduz o código 11630 para obteres instruções para estas ideias de entretenimento.
 Bezoek www.knex.com/instructions en duid de 11630 code aan om de aanwijzingen voor deze spelideeën terug te vinden.

WARNING:

CHOKING HAZARD - Small parts.
Not for children under 3 years.

AVERTISSEMENT:

DANGER D'ÉTOUFFEMENT - Pièces de petite taille.
Ne pas donner aux enfants de moins de 3 ans.

11630/71320

Product and colors may vary. Most models can be built one at a time. K'NEX and Imagine, Build, Play are registered trademarks of K'NEX Limited Partnership Group. Manufactured under U.S. Patents/Fabrique sous brevets américains/Fabricado bajo patentes de EE.UU. 5,061,219; 5,199,919; 5,350,331; 7,267,598; D553,204; D550,784; 5,137,486; D412,020; D553,203. Other U.S. and foreign patents pending. Autres brevets américains et étrangers en instance. Otras patentes de EE.UU. y países extranjeros pendientes. Community design no./Le dessin ou modèle communautaire/Número de diseño de comunidad 000 645338-001-0002. (FR) Produits et couleurs peuvent varier. La plupart des modèles ne peuvent être construits que un à un. K'NEX et Imagine, Build, Play sont des marques déposées de K'NEX Limited Partnership Group. Autres brevets américains et étrangers en instance. (ES) El producto y los colores pueden variar. La mayoría de los modelos se puede construir uno a la vez. K'NEX y Imagine, Build, Play son marcas registradas de K'NEX Limited Partnership Group. Otras patentes de EE.UU. y países extranjeros pendientes.

©2010 K'NEX Limited Partnership Group
 P.O. Box 700
 Hatfield, PA
 19440-0700
 USA
 410530.11-V1-11/09

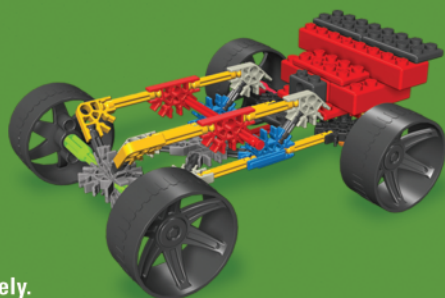
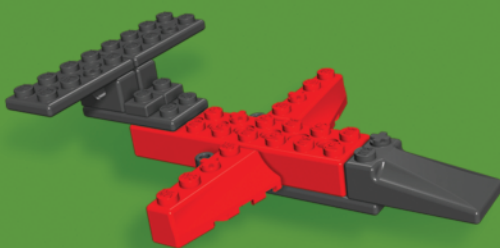

Sold separately.
 Vendus séparément.
 Se venden por separado.
 Separat erhältlich.
 Venduti separatamente.
 Vendidos separadamente.
 Afzonderlijk verkocht.

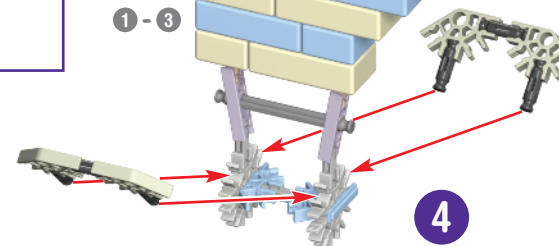
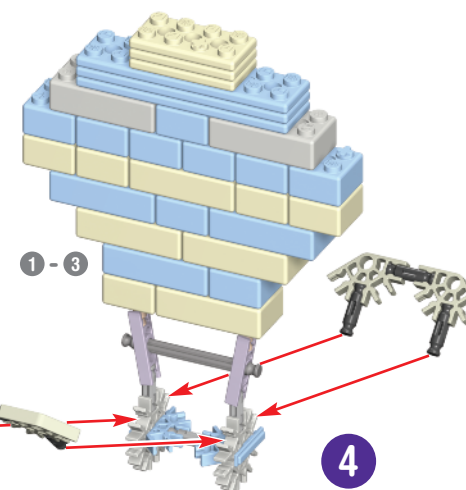
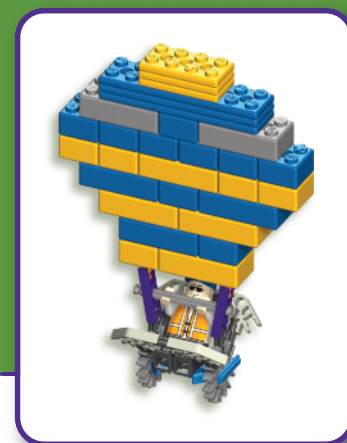
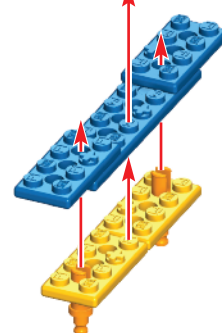
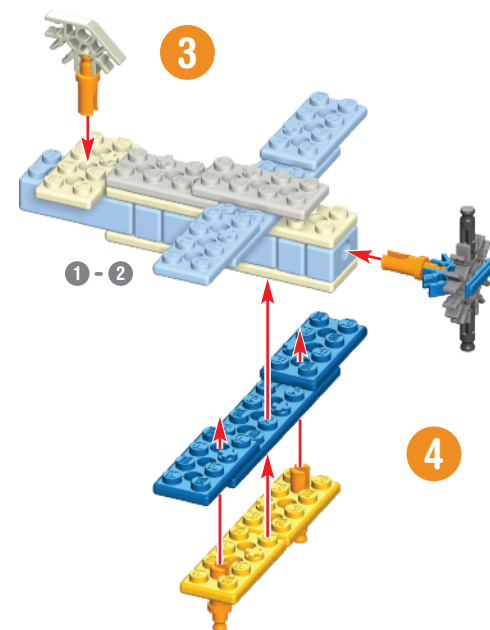
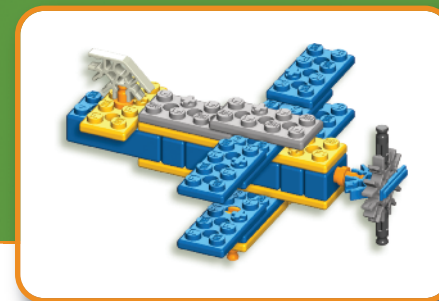
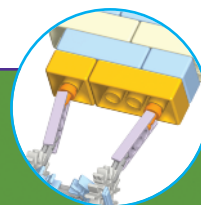
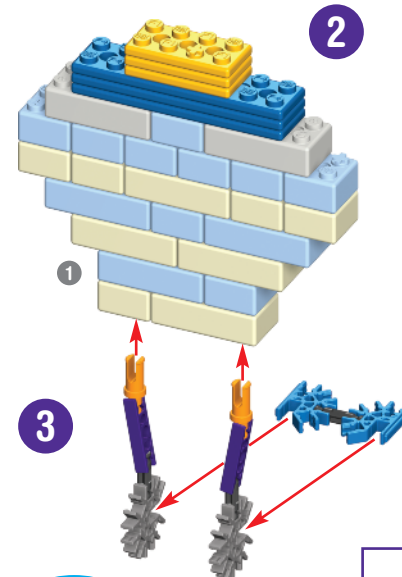
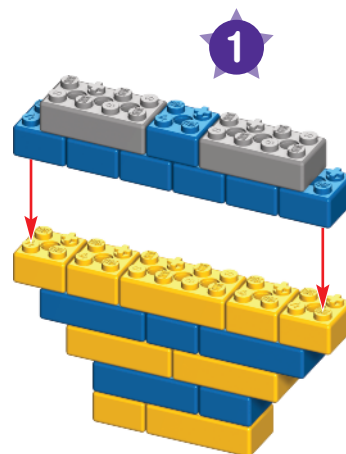
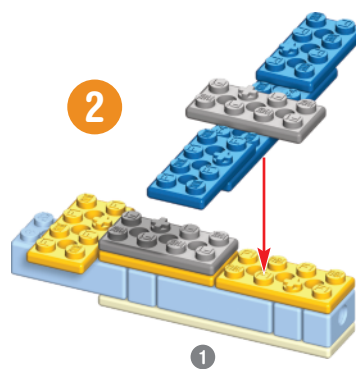
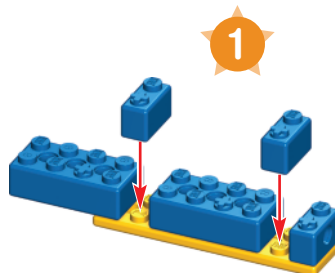
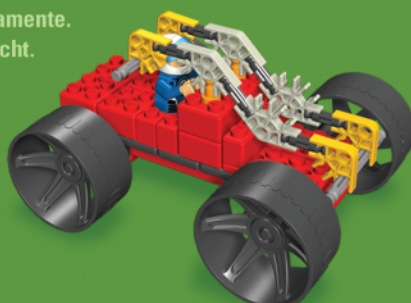

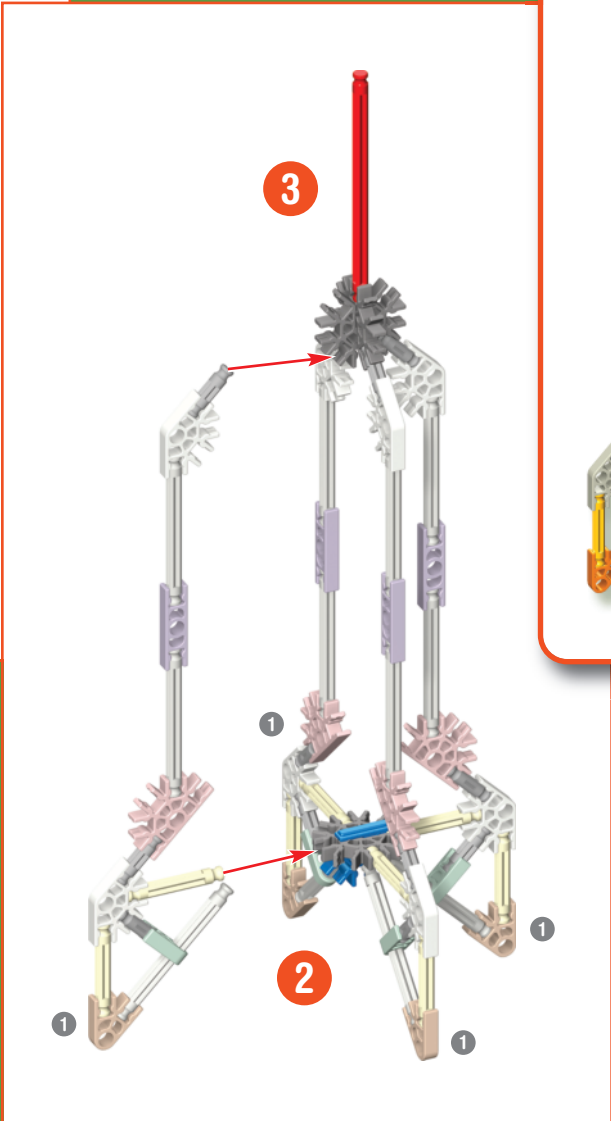
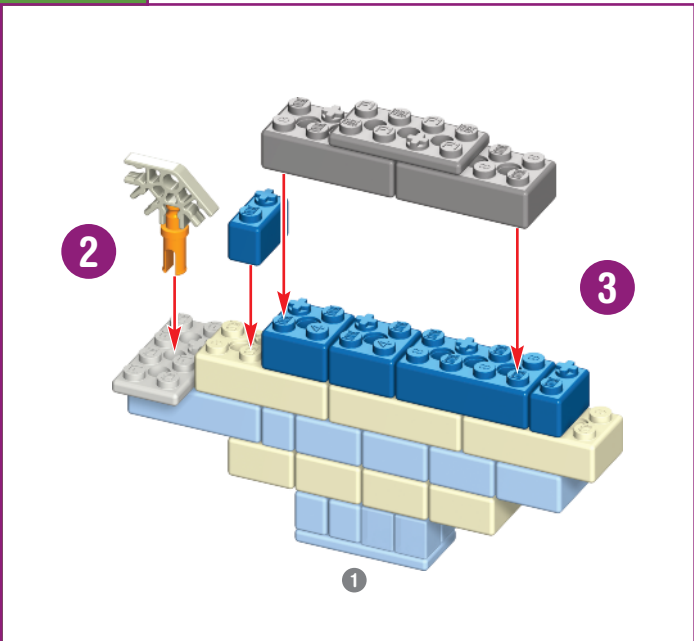
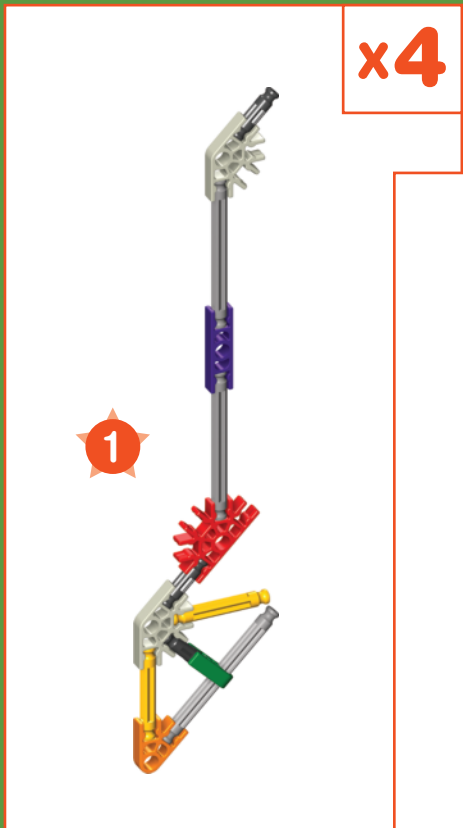
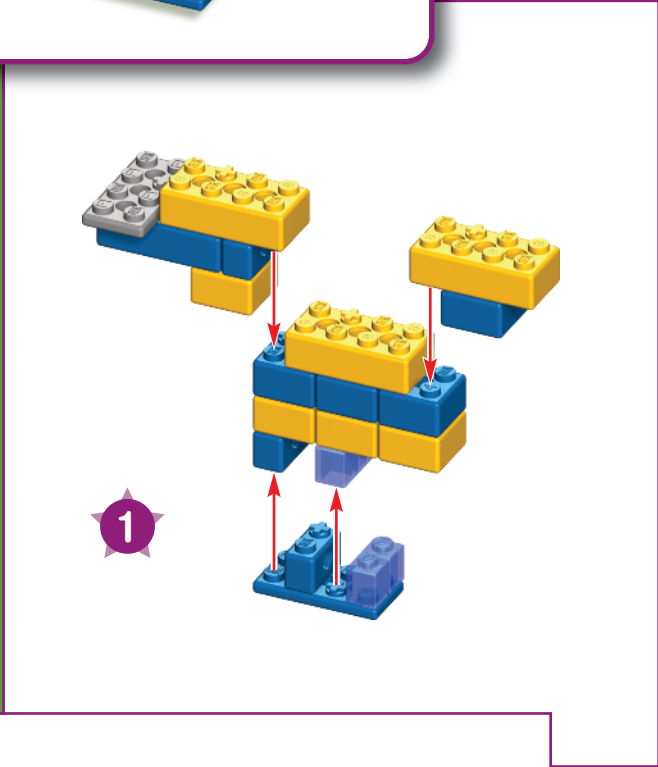
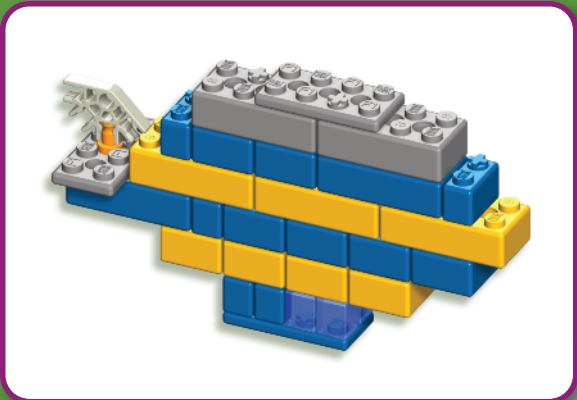
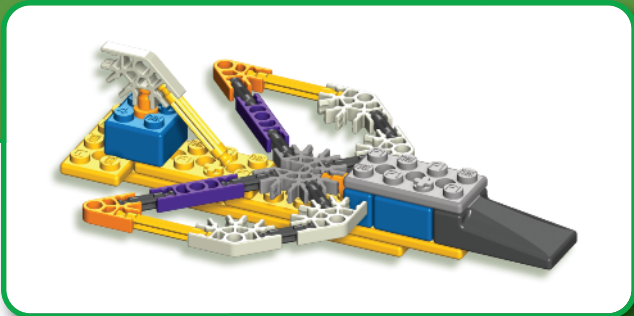
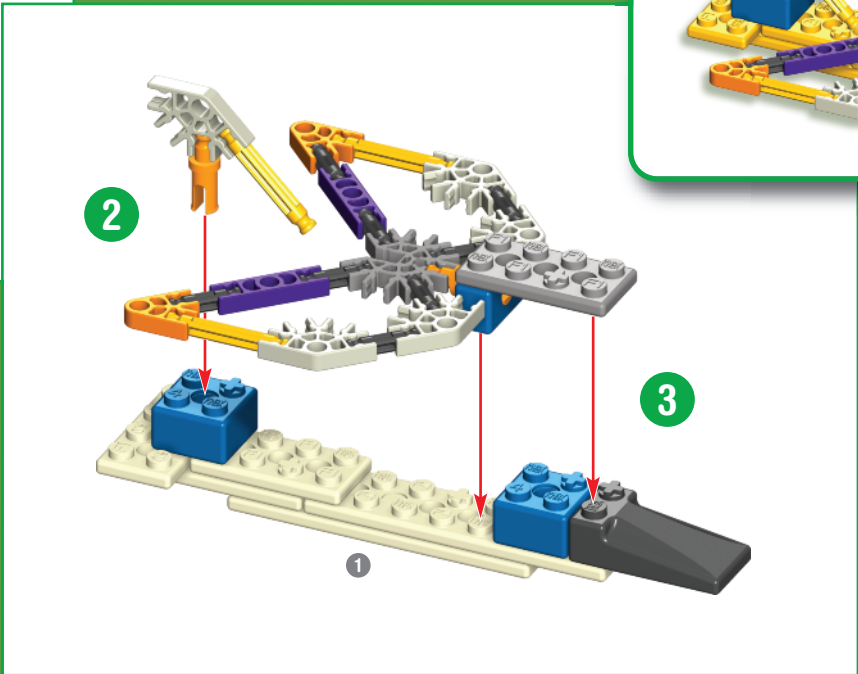
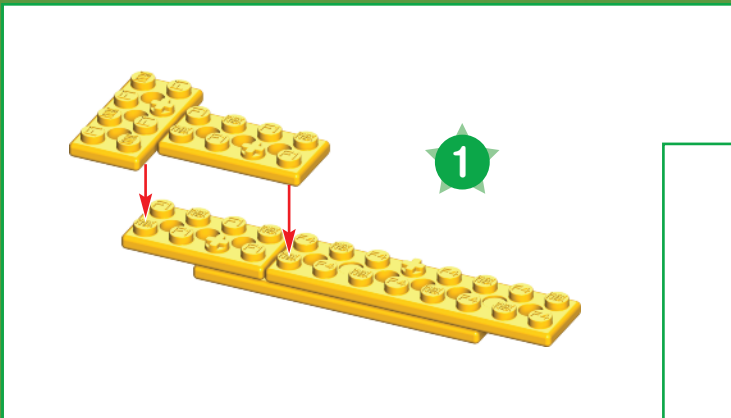

- Identifies Genuine K'NEX Bricks.
- Identifie ce sont d'authentiques briques K'NEX.
- Identifica los ladrillos genuinos de K'NEX.
- Identifiziert echte K'NEX-Bausteine.
- Edentifica i veri blocchi K'NEX.
- Identifica que são cubos genuinos da K'NEX.
- Identificeert K'NEX bakstenen voor.

